

T. 14 S., R. 31 E., W. M.

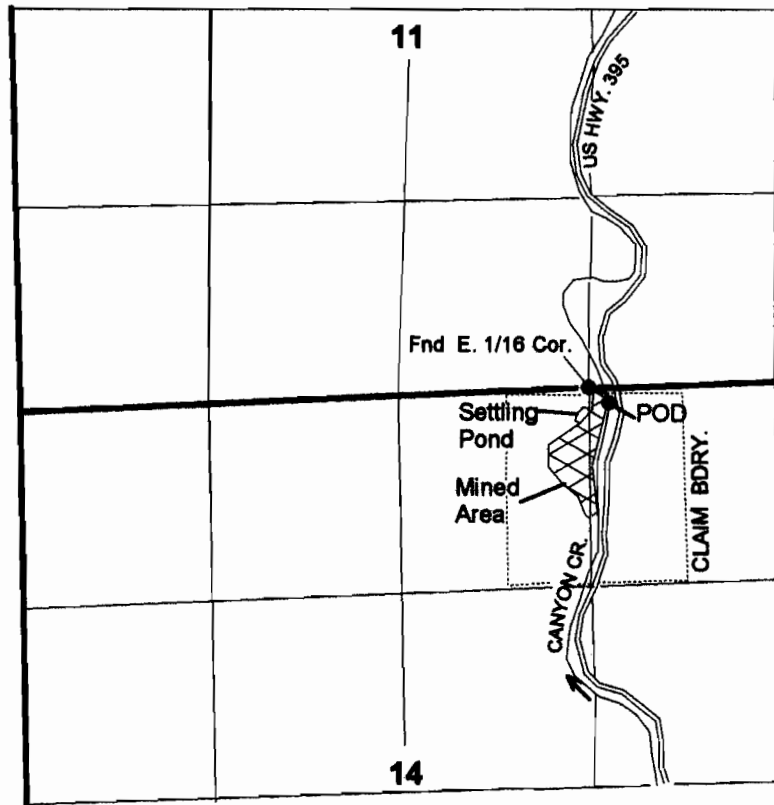

1" = 1320'

POD LOCATED 104' SOUTH AND 132' EAST FROM THE NW CORNER OF THE NE 1/4 NE 1/4 OF SECTION 14.

FINAL PROOF SURVEY

UNDER

Application No. 64136 Permit No. 47107

IN THE NAME OF

GERALD AND VIRGINIA VIEIRA

Surveyed August 25, 2000 by J. Miller

RECEIVED

OCT 3 0 2002

WATER RESOURCES DEPT.
SALEM, OREGON