

T. 12S., R. 22E., W.M.

APPLICATION MAP FOR

FRED & JUNE HANSON

Div. #1 - 2660'S & 2000'W
Div. #2 - 280'S & 780'E
Div. #3 - 680'N & 700'E
All from NE corner Sec. 32

RECEIVED
AUG 22 1983
WATER RESOURCES DEPT.
SALEM, OREGON

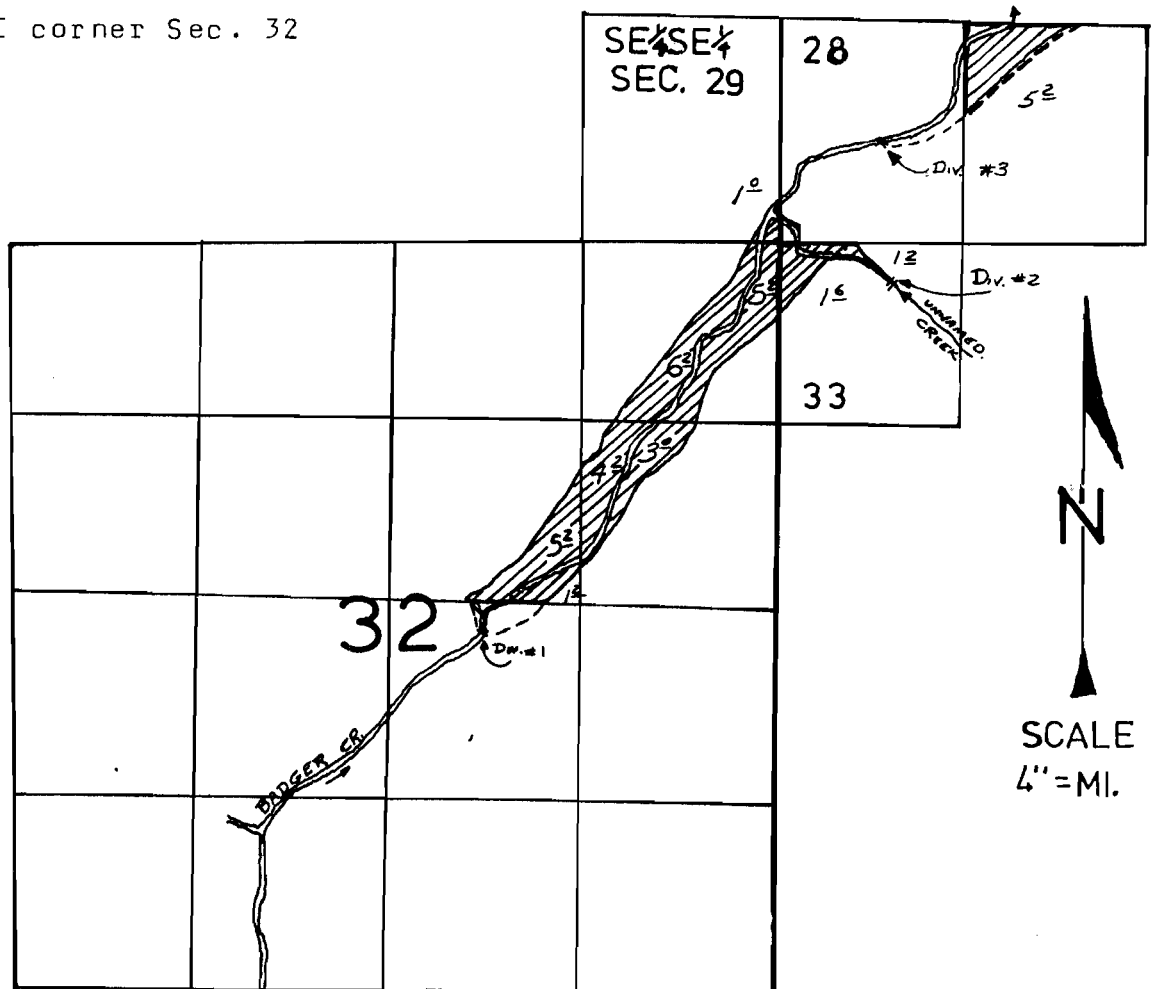

Application No. 65586
Permit No. 47999