

FINAL PROOF SURVEY

UNDER

APPL. NO. G-12424 PERMIT NO. G-11332

IN THE NAME OF JERRY D. ARNEY

PERMIT NO. G-11332 DATED SEPTEMBER 3, 1991 - 126.6 ACRES

T14S, R12E, W.M.

RECEIVED
JUL 1 1994
WASHER
SHEET 1 OF 1

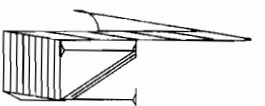

SCALE 1" = 1320'

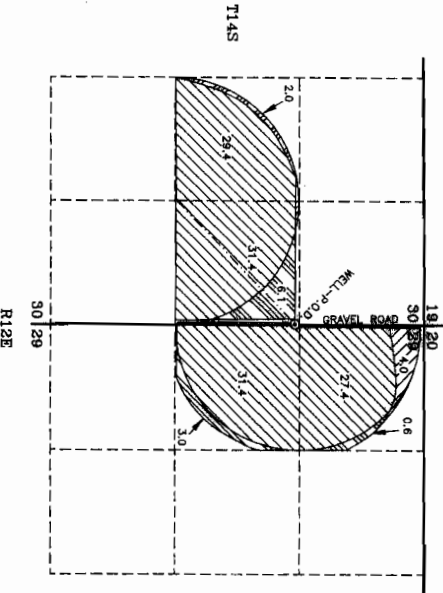

- LEGEND**
- SECTION LINE
 - 1/4, 1/4 SECTION LINE
 - IRRIGATION MAINLINE
 - WELL - POINT OF DIVERSION LOCATED 1275' NORTH & 10' WEST OF THE 1/4 CORNER COMMON TO SECTIONS 29 & 30, T14S, R12E.
 - AREA BEING IRRIGATED BUT NO CROP CURRENTLY PLANTED PROOFED THIS SURVEY UNDER PERMIT NO. G-11332 (PRIMARY)
 - AREA PROOFED THIS SURVEY UNDER PERMIT NO. G-11332 (PRIMARY)
 - AREA WITH WATER BEING APPLIED NOT COVERED UNDER PERMIT NO. G-11332
 - AREA COVERED UNDER PERMIT NO. G-11332 WITH NO WATER BEING APPLIED

RENEWAL 12/31/94

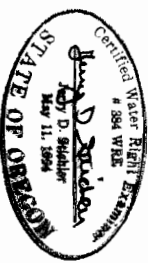

NOTES
PREPARATION OF THIS MAP IS FOR PURPOSES OF IDENTIFYING PROPOSED WATER RIGHTS ONLY. IT HAS NO INTENT TO PROVIDE DIMENSIONS OR LOCATIONS OF PROPERTY BOUNDARIES.

00811111 0190

<p>PREPARED FOR: JERRY D. ARNEY 70329 LOWER BRIDGE ROAD TERREBONNE, OREGON 97760 (503) 548-5735</p>	
<p>PREPARED BY: ANDERSON ENGINEERING & SURVEYING 539 SW 7TH STREET - P.O. BOX 419 REDMOND, OREGON 97756 (503) 923-4307 JUNE 1, 1994</p>	<p>SHEET 1 OF 1</p>
<p>COGO: 9432FP</p>	<p>ACAD: 9432FP</p>