

T. 4 S., R. 12 E., W. M.

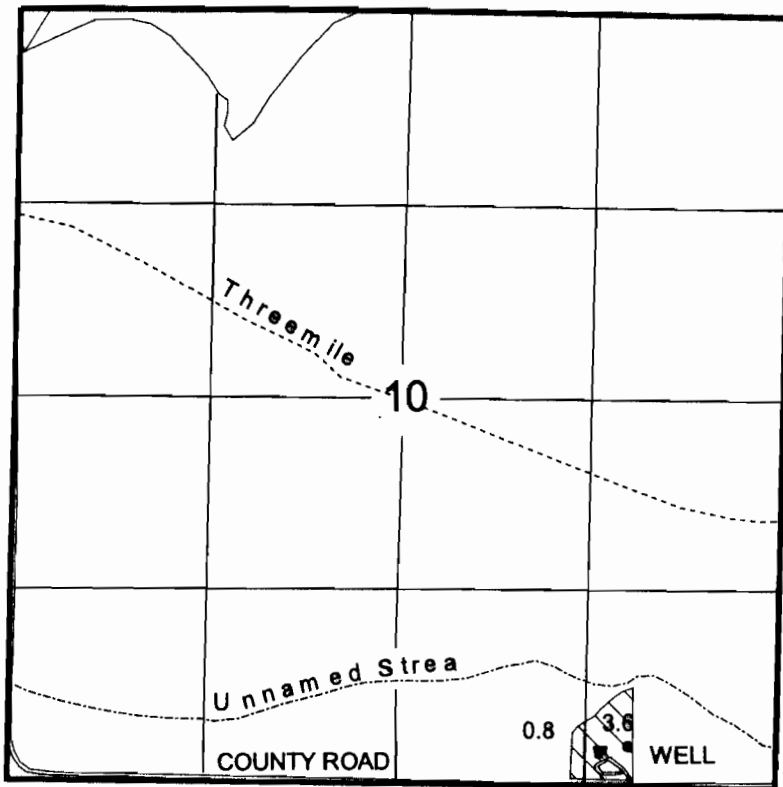

Well - 250' North and 1050' West from the Southeast corner of Section 10.

FINAL PROOF SURVEY UNDER

Application No. G-8319 Permit No. G-7685
IN THE NAME OF

PAUL AND COLETE TREANOR

Surveyed 6-05-2001, by J. Miller