

T. 1 N., R. 10 E., W.M.

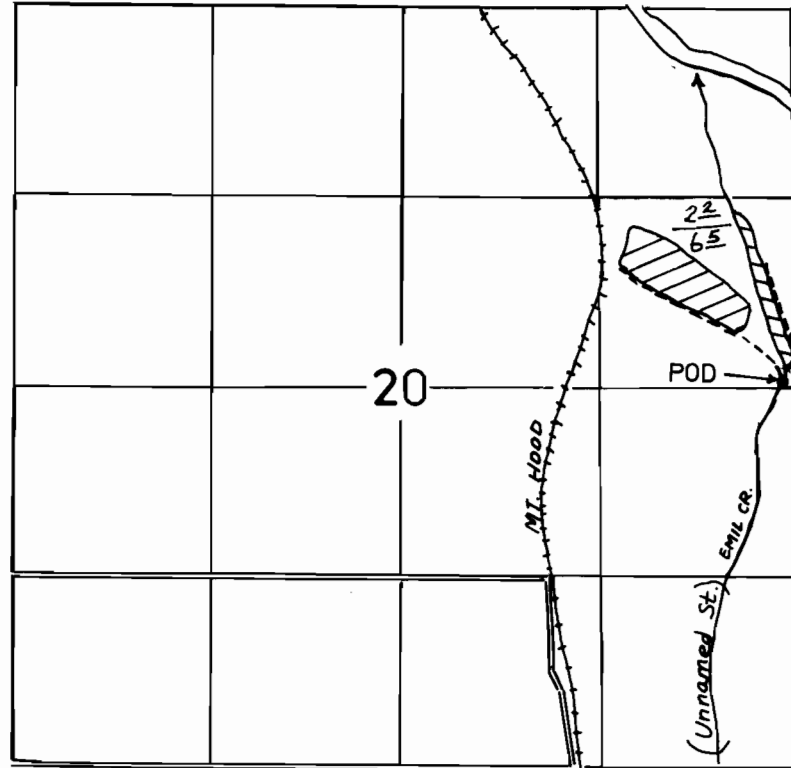

POD 10' N. & 100' W. FROM E 1/4 COR. SEC. 20.



FINAL PROOF SURVEY UNDER

Application No. 46046 Permit No. 34386
IN NAME OF

DUANE PERRON

Surveyed JANUARY 12, 1993, by J. MILLER