

T.2N., R.12E., W.M.

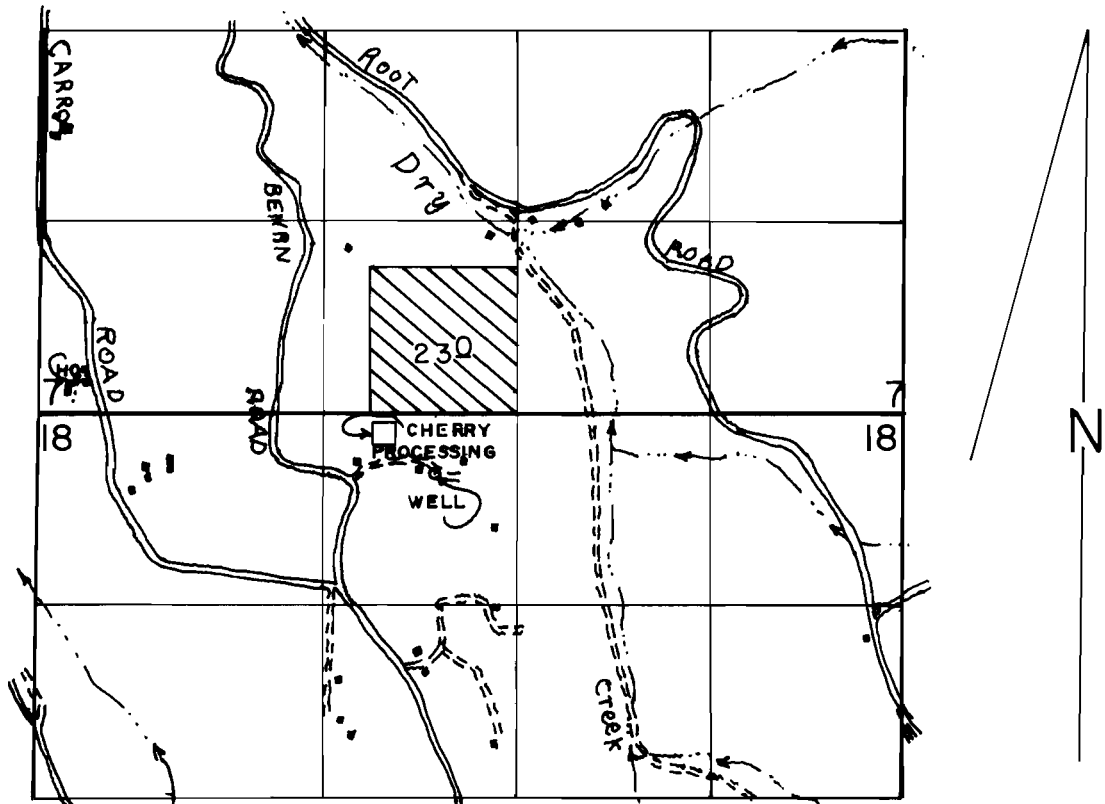

WELL LOC: 380' S & 550' W FROM N1/4 COR. OF SEC 18.

SCALE: 1" = 1320'

FINAL PROOF SURVEY UNDER

Application No. G-10989 Permit No. G-10168
IN NAME OF

.....BRYCE.....MOLESWORTH.....

Surveyed APRIL 25 19.95, by R.M.SUTTERFIELD