

T. 1 N, R. 12 E, WM

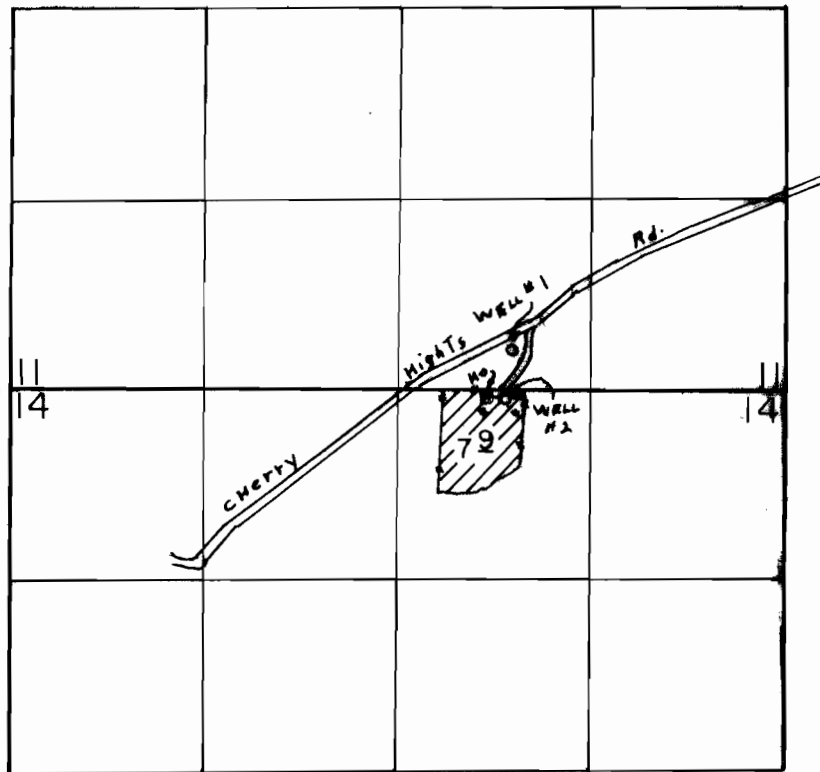

WELL 1 LOC: 270' N & 1860' W FROM SE COR. OF SEC 11.
WELL 2 LOC: 60' S & 1900' W FROM NE COR. OF SEC 14.

SCALE: 1" = 1320'

FINAL PROOF SURVEY
UNDER

APPLICATION NO. G-10460 PERMIT NO. G-9641
IN NAME OF

MICHAEL B. DONIVAN

SURVEYED AUG 15, 1995, BY R.M. SUTTERFIELD