

T. 16 S., R. 43 E., W.M.

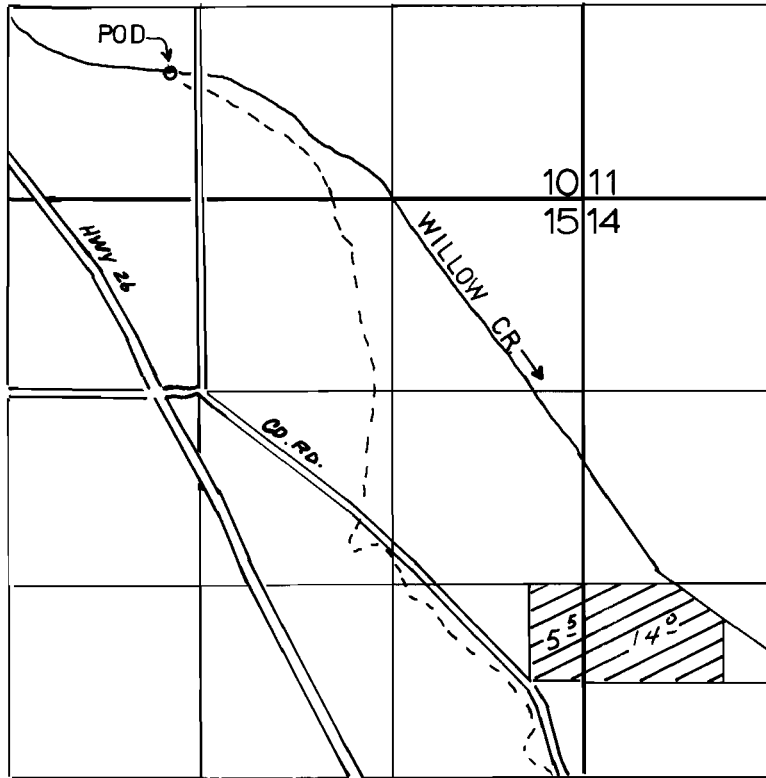

POD - 840' N. & 180' W. OF THE S 1/4 COR. SEC. 10.

FINAL PROOF SURVEY

UNDER

Application No. 56201 Permit No. 50181

IN NAME OF

ROBERT D. MAAG

Surveyed 8-13, 1993, by J. MILLER