

T. 2. N., R. 26 E., W.M.

RECEIVED

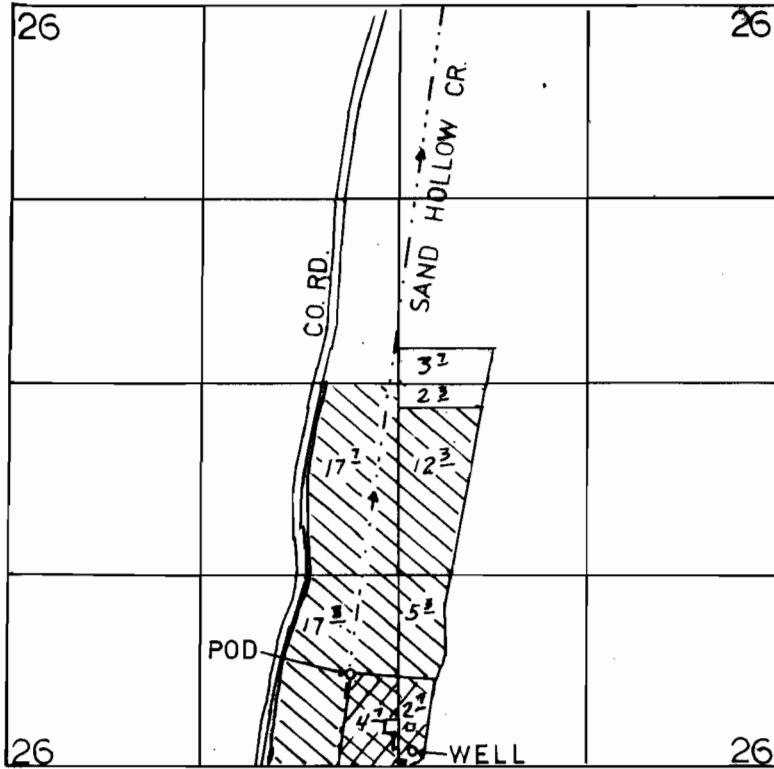

JUL 8 1998

WATER RESOURCES DEPT.
SALMON, OREGON



1" = 1320'

POD ON CR. - 650' N. & 320' W. of the S. 1/4 COR. SEC. 26.
POA - WELL - 100' N. & 70' E. of the S. 1/4 COR. SEC. 26.

-  P# 49229
-  T# 5892 SUPP.

FINAL PROOF SURVEY

UNDER

Application 68252 Permit 49229

and

Transfer 5892

IN NAME OF

JAMES H. KLUKKERT

Surveyed 10-14, 1993, by J. MILLER