

T. 6 N. R. 35 E. W.M.

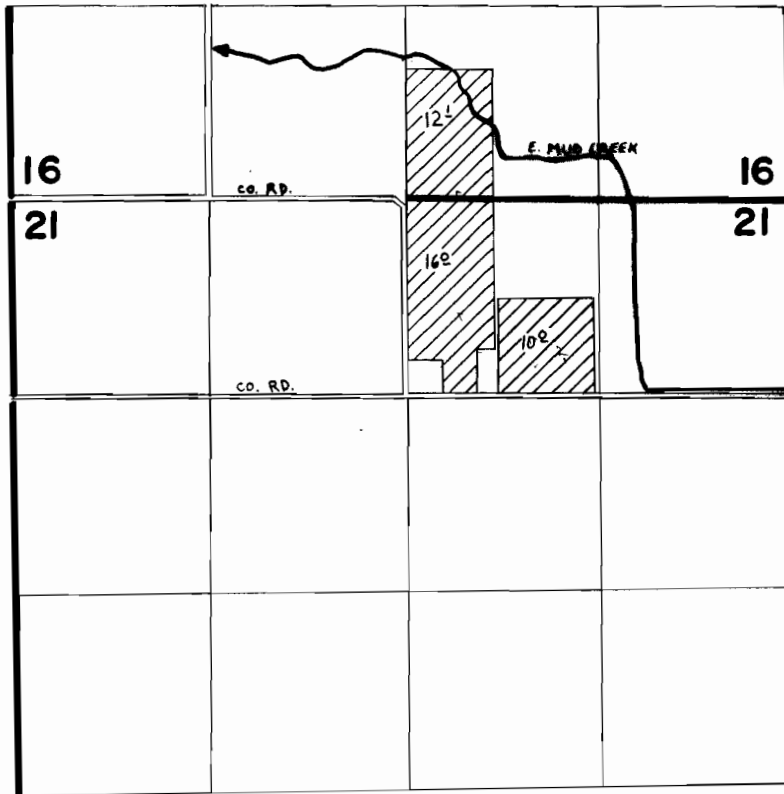

E 1/2 NW 1/4 & NE 1/4 Sec. 27, T. 6 N., R. 35 E.

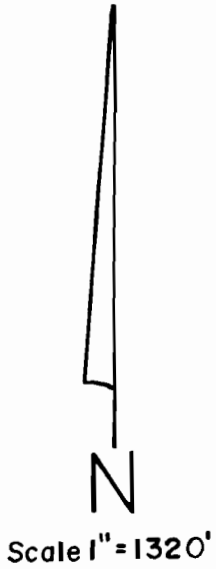
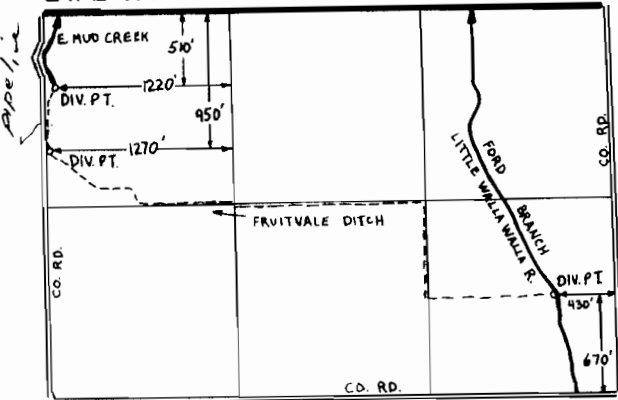

NE 1/4 Sec. 12, T. 5 N., R. 35 E.

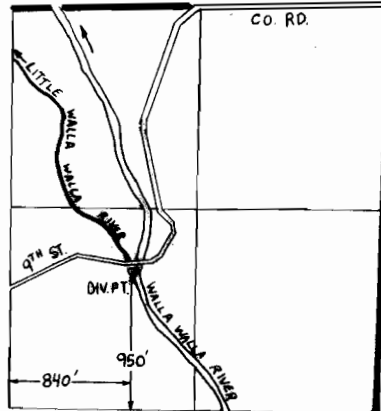

FINAL PROOF SURVEY UNDER

Application No. 65251... Permit No. 47893.....
IN NAME OF

EAST MUD CREEK WATER USERS DIST.

Surveyed March 16, 1987., by .V. Church.....