

File Copy - DO NOT REMOVE

**TOWNSHIP 5 NORTH, RANGE 29 EAST, W. M.**

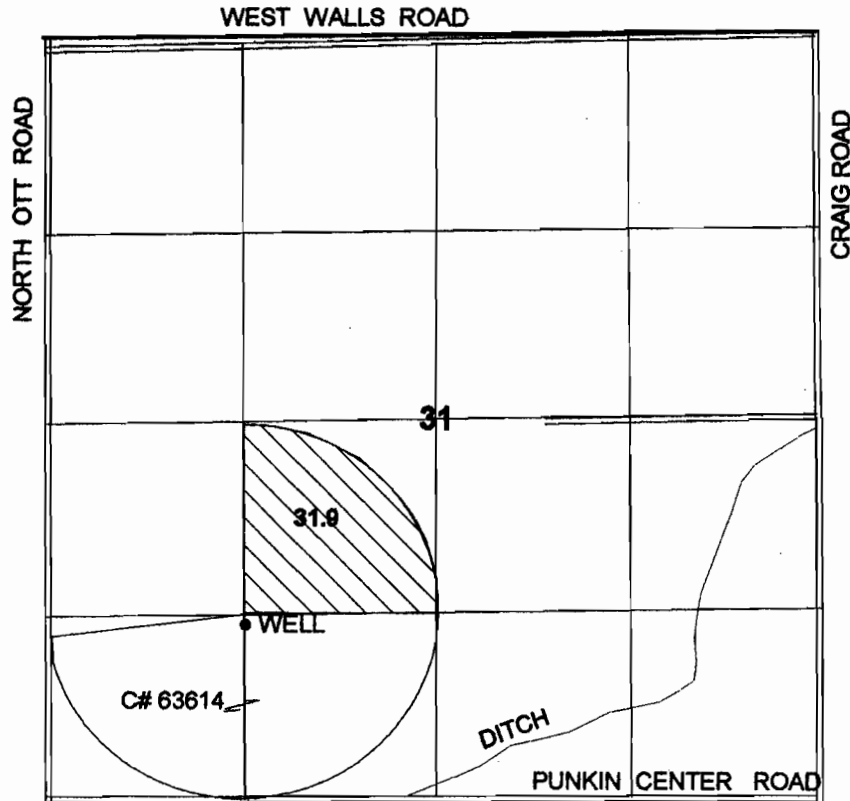

WELL - 1410' SOUTH & 1310' WEST FROM THE CENTER  
CORNER OF SECTION 31.

**FINAL PROOF SURVEY**  
UNDER  
Application G-11251, Permit G-10451

IN THE NAME OF  
**CHARLES A. BLOODSWORTH**

Surveyed: May 7, 2002 by: J. Miller

**RECEIVED**

FEB 03 2003

WATER RESOURCES DEPT.  
SALEM, OREGON