

RECEIVED

JUN 17 2002

WATER RESOURCES DEPT.
SALEM, OREGON

ROGUE RIVER
T. 36S., R. 2W., W.M.

CTR. 1/4 COR. SEC. 15

POINT OF DIVERSION
(SAME AS CERTIFICATE # 34239)
IS 2438 N. 1450 W. OF S.E.
COR. SEC. 15

GOV'T LOT 3

GOV'T LOT 2

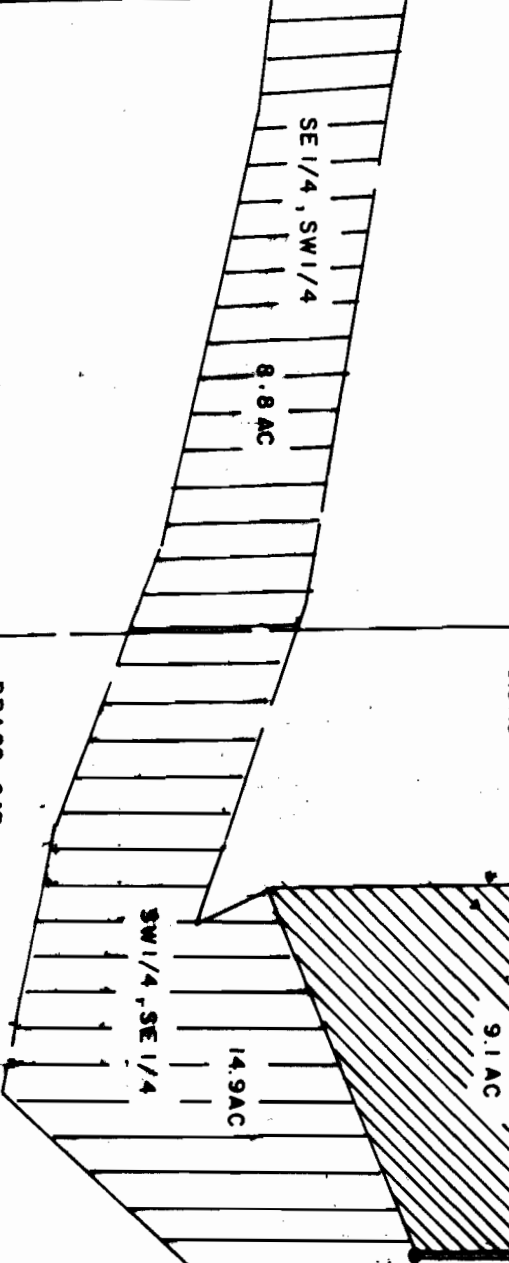
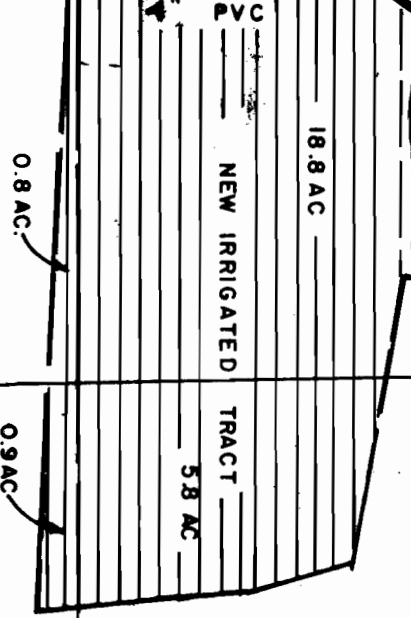

EXISTING 10" STEEL PIPELINE



SCALE: 1"=400'



Legend:



FORMER "IRRIGATED TRACT"
CURRENT IRRIGATED AREA WITH
"NO CHANGE" OF 23.7 ACRES
ABOVE GROUND IRRIGATED AREA
IS BY A TRAVIS WHEEL LINE
THE NEW IRRIGATED TRACT IS
IRRIGATED WITH A 10" STEEL
PIPELINE, (EXISTING) AND 6"
4 AND 3" PVC BURIED PIPELINES
A NELSON BIG GUN

Claim of Beneficial Use

Applicant: ROBERT MACE
8825 HIGHBANKS ROAD
CENTRAL POINT, OR. 97502
T-8594, TRV.
Special Order Volume 55,
Page 1065

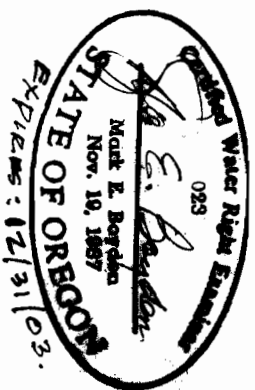

MAP PREPARED JUNE 15, 2002 BY MARK E. BOYDEN

