

T. 23S., R. 27E., W. M.

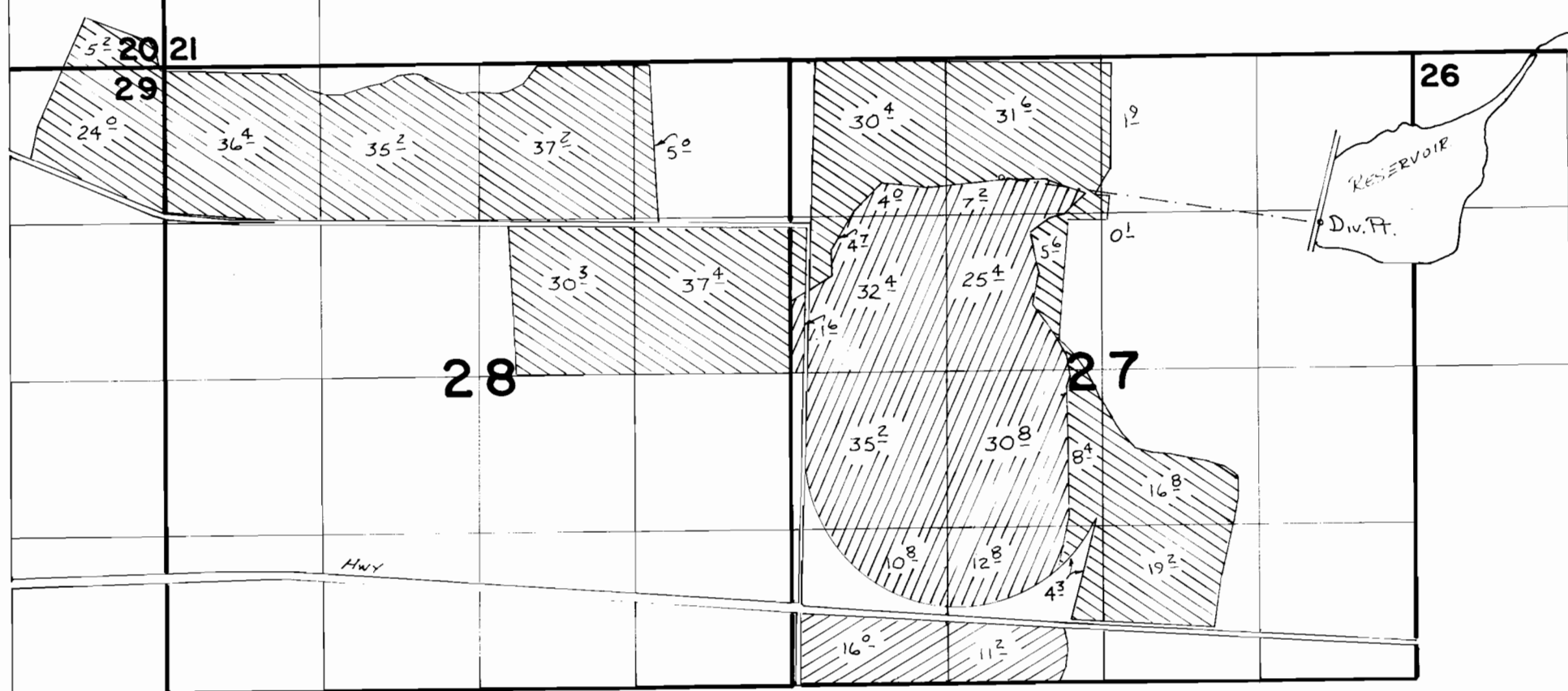



FINAL PROOF SURVEY UNDER

APPL. 57108
54310

PER. 42944
41553

IN NAME OF

R. M. HEGEWALD
Surveyed May 10 1988, by B.W. Bishop

PRIM-  41553
 SUPPL-  41553
 42944

Div. Pt. Loc: 1410'S. & 790'W. FROM NE COR. SEC 27



Scale 1" = 1320'