

T. 23S., R. 27E., W. M.

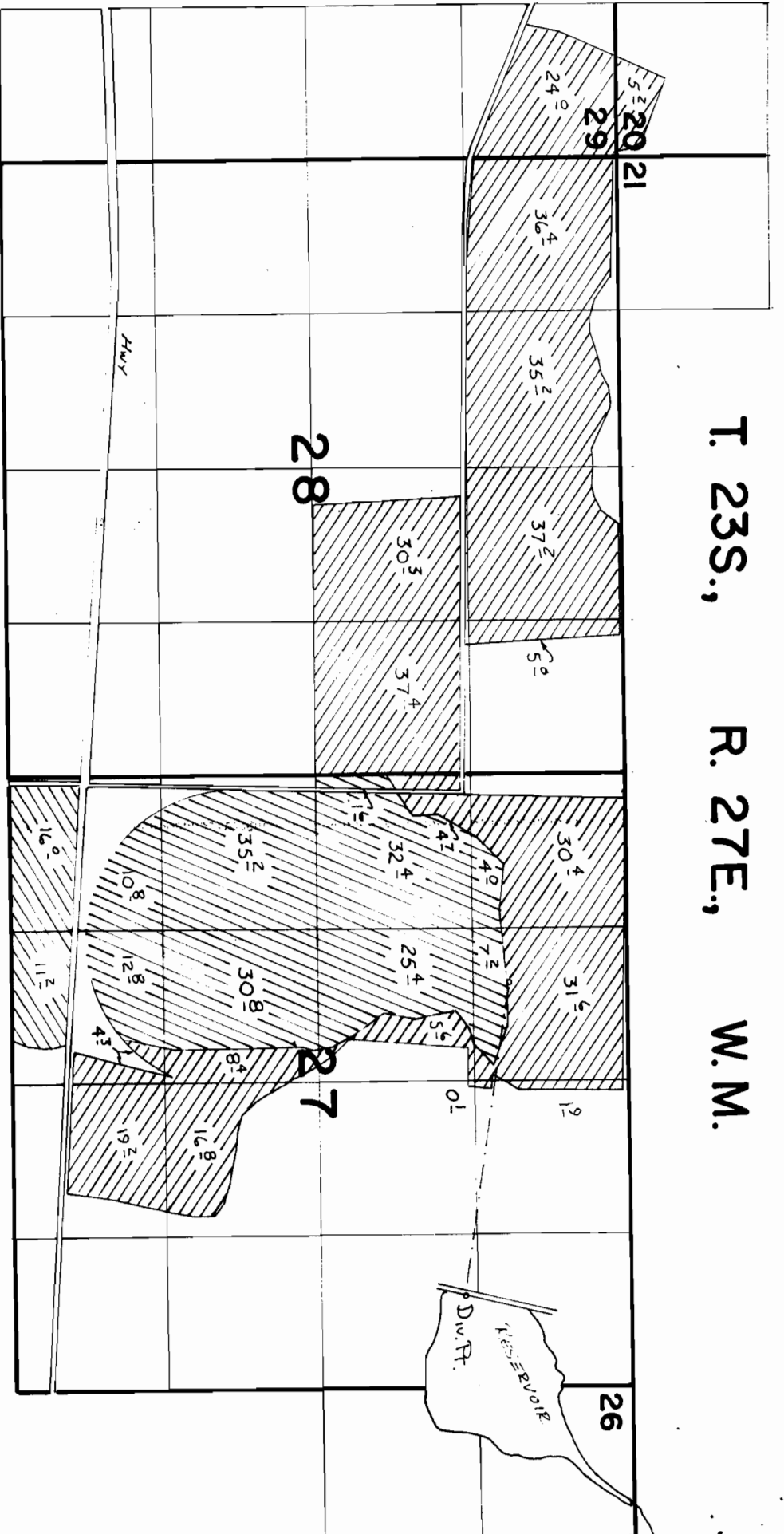

# FINAL PROOF SURVEY

UNDER

APPL. 57108 PER. 42944  
54310 41553  
IN NAME OF

R. M. HEGEWALD  
Surveyed May 10 1988, by B.W. Bishop

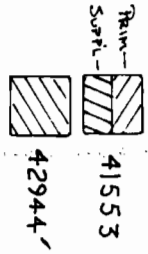

Div. Pt. Loc: 1410'S. & 790'W. From NE Cor. Sec 27

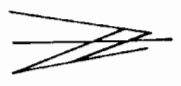

Scale 1" = 1320'