

# T. 13 S., R. 31 E., W.M.

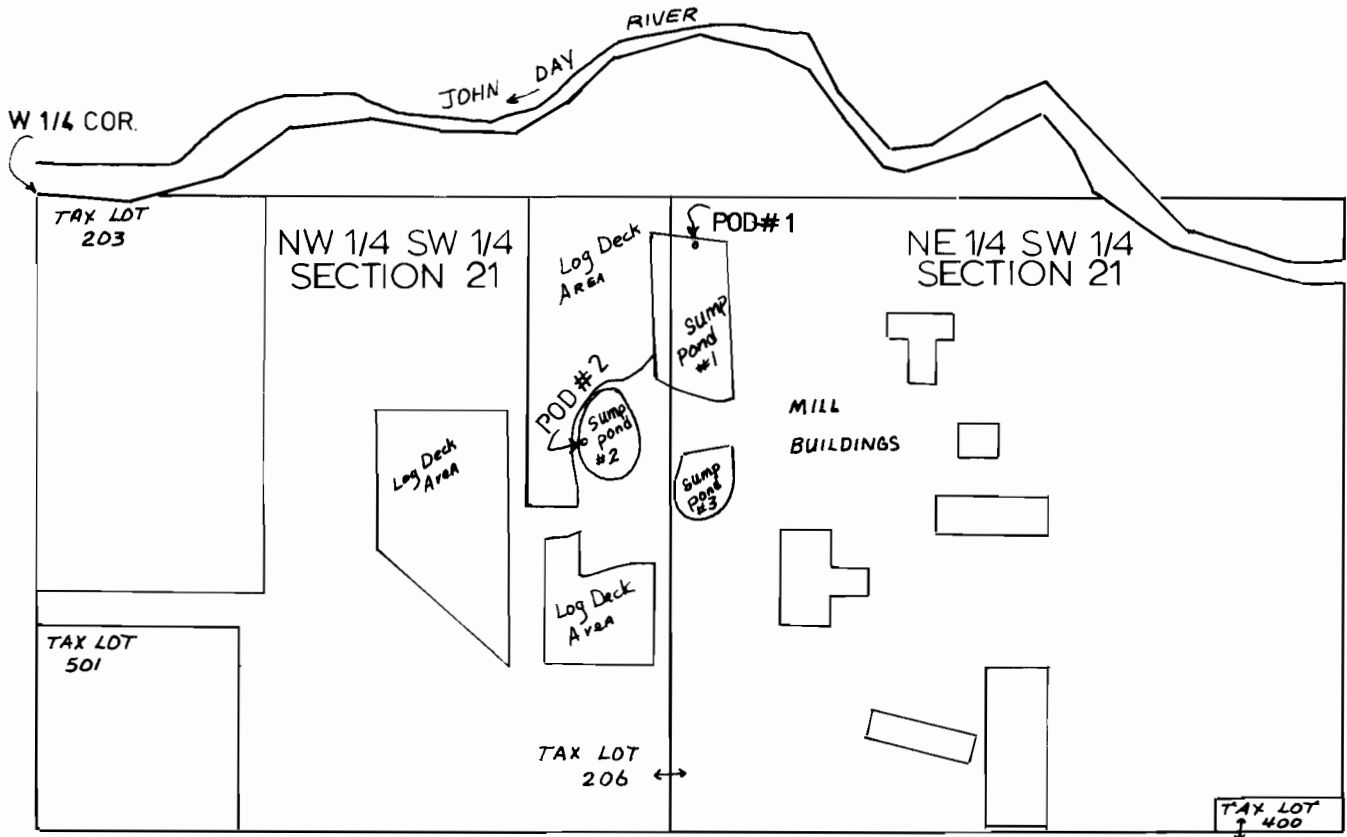

POD # 1, 100' S. AND 1370' E.  
POD # 2, 510' S. AND 1140' E., BOTH FROM THE W 1/4 CORNER, SEC. 21.



## FINAL PROOF SURVEY

UNDER

Application No. G-11412 Permit No. G-10528  
IN NAME OF

MALHERU LUMBER COMPANY  
**MALHEUR**

Surveyed DECEMBER 5, 1991, by J. MILLER

1" = 400'