

T. 13 S., R. 33 E., W.M.

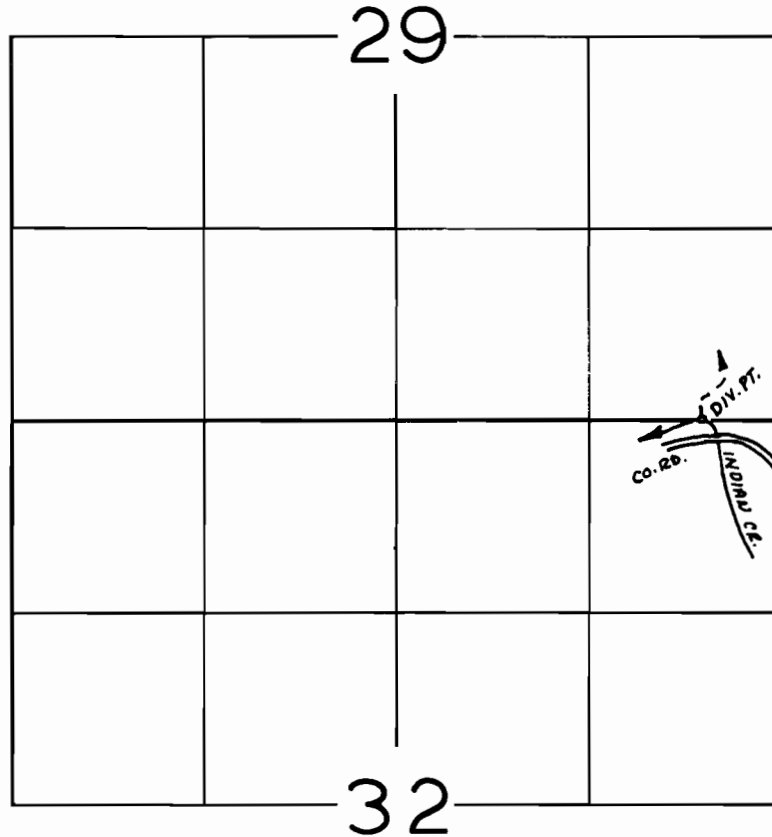

DIV. PT. LOC.: 10' N & 540' W FROM SE COR. SEC. 29

FINAL PROOF SURVEY

UNDER

TRANSFER No. 4550

Application No. Permit No.

IN NAME OF

J. A. & SUSAN HEASTON

Surveyed July 19 1983, by R.W. CETTEL