

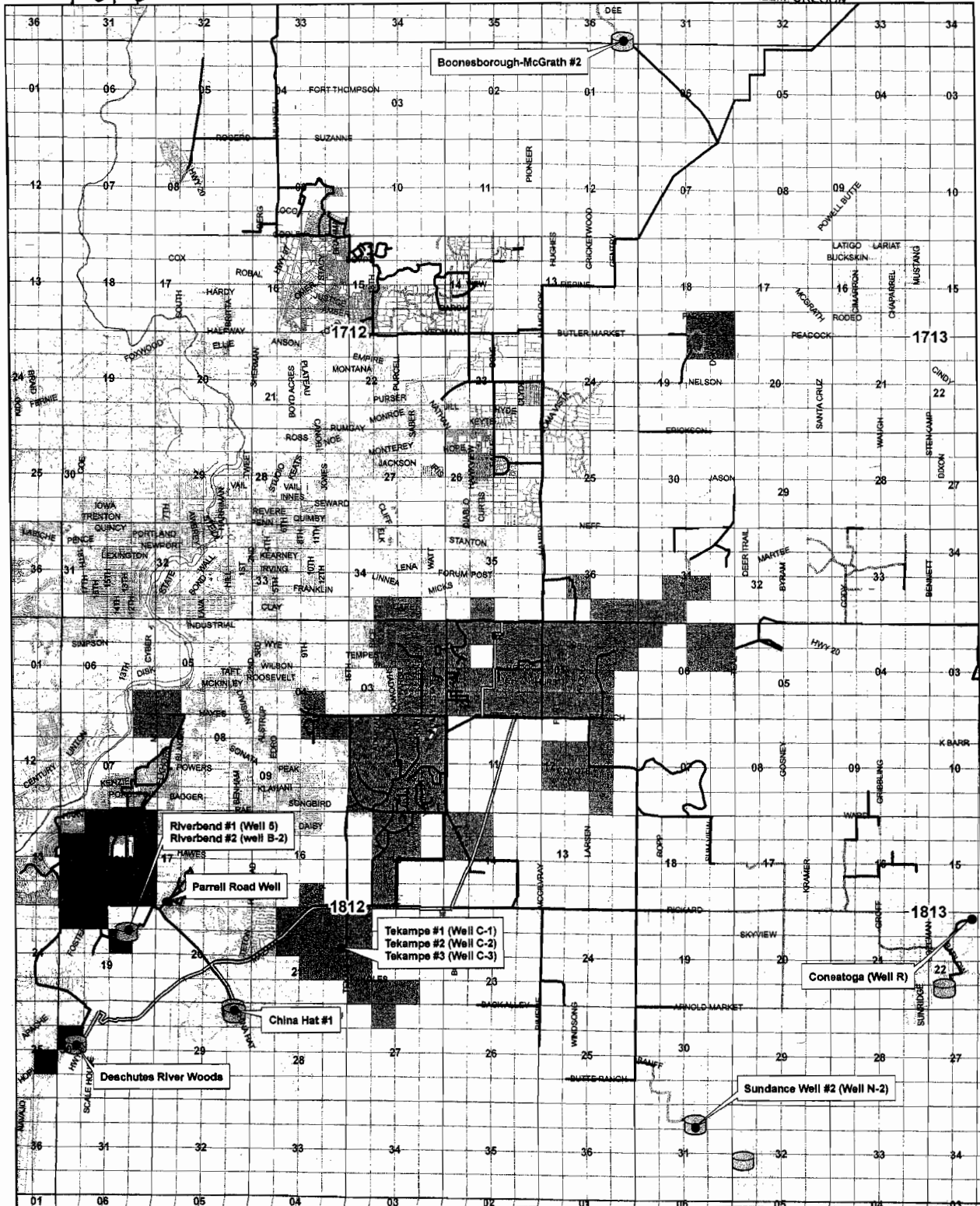

1 of 6



1 inch equals 5,280 feet  
 0 2,500 5,000 10,000 Feet

DRAWN BY: TANNER LEMMON  
 AVION WATER GIS DEPARTMENT  
 JUNE, 2006

PLACE OF USE	
	PERMIT (G-9217)
	PERMIT (G-9269)
	PERMIT (G-9320)
	PERMIT (G-9846)
	PERMIT (G-9948)
	PERMIT (G-9975)
	PERMIT (G-9976)

**DISCLAIMER:**  
 This map was prepared for the purpose of identifying the location of water rights only and is not intended to provide legal dimensions or locations of property ownership lines.

	24-dom		12-dom		4-dom
	20-dom		10-dom		3-dom
	18-dom		8-dom		2-dom
	16-dom		6-dom		
	14-dom		5-dom		
	Points of Appropriation		Storage		

# AVION WATER CO, INC.

SUPPLEMENTAL CLAIM OF BENEFICIAL USE - PLACE OF USE MAP

Attachment 5

T-7779 / Permit G-9217

1 of 4

02 09  
3 of 6



1 inch equals 1,320 feet

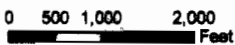

DRAWN BY: TANNER LEMMON  
AVION WATER GIS DEPARTMENT  
CWRE: TERRY SPRECHER  
JUNE, 2006

PERMIT G-9217  
 DESCHUTES RIVER

**DISCLAIMER:**  
This map was prepared for the purpose of identifying the location of water rights only and is not intended to provide legal dimensions or locations of property ownership lines.

Certified Water Right Examiner  
445WRE  
  
Terry Ann Sprecher  
06/13/97  
STATE OF OREGON

RECEIVED  
JUN 22 2006

**NOTES:**  
- Please refer to "Attachment 1" for location of Distribution Piping  
- Please refer to "Attachment 2" for Point of Appropriation locations

WATER RESOURCES DEPT  
SALEM, OREGON