

AVION WATER CO, INC.

CLAIM OF BENEFICIAL USE - PLACE OF USE MAP
Attachment 5

Application G-10378 Permit G-9975

2 of 2

JUN 22 2008
WATER RESOURCES DEPT
SALEM OREGON

T17S R12E

4 of 4

0206

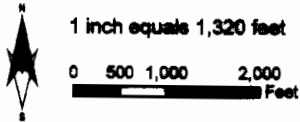

DRAWN BY: TANNER LEMMON
AVION WATER GIS DEPARTMENT
CWRE: TERRY SPRECHER
JUNE, 2008

PERMIT G-9975



DISCLAIMER:
This map was prepared for the purpose of identifying the location of water rights only and is not intended to provide legal dimensions or locations of property ownership lines.

NOTES:
- Please refer to "Attachment 1" for location of Distribution Piping
- Please refer to "Attachment 2" for Point of Appropriation locations

AVION WATER CO, INC.

CLAIM OF BENEFICIAL USE - PLACE OF USE MAP
Attachment 5

1 of 2

02.06.304

Application G-10378 Permit G-9975

WATCH PERMITS REPORT
SALEM OREGON T17S R12E

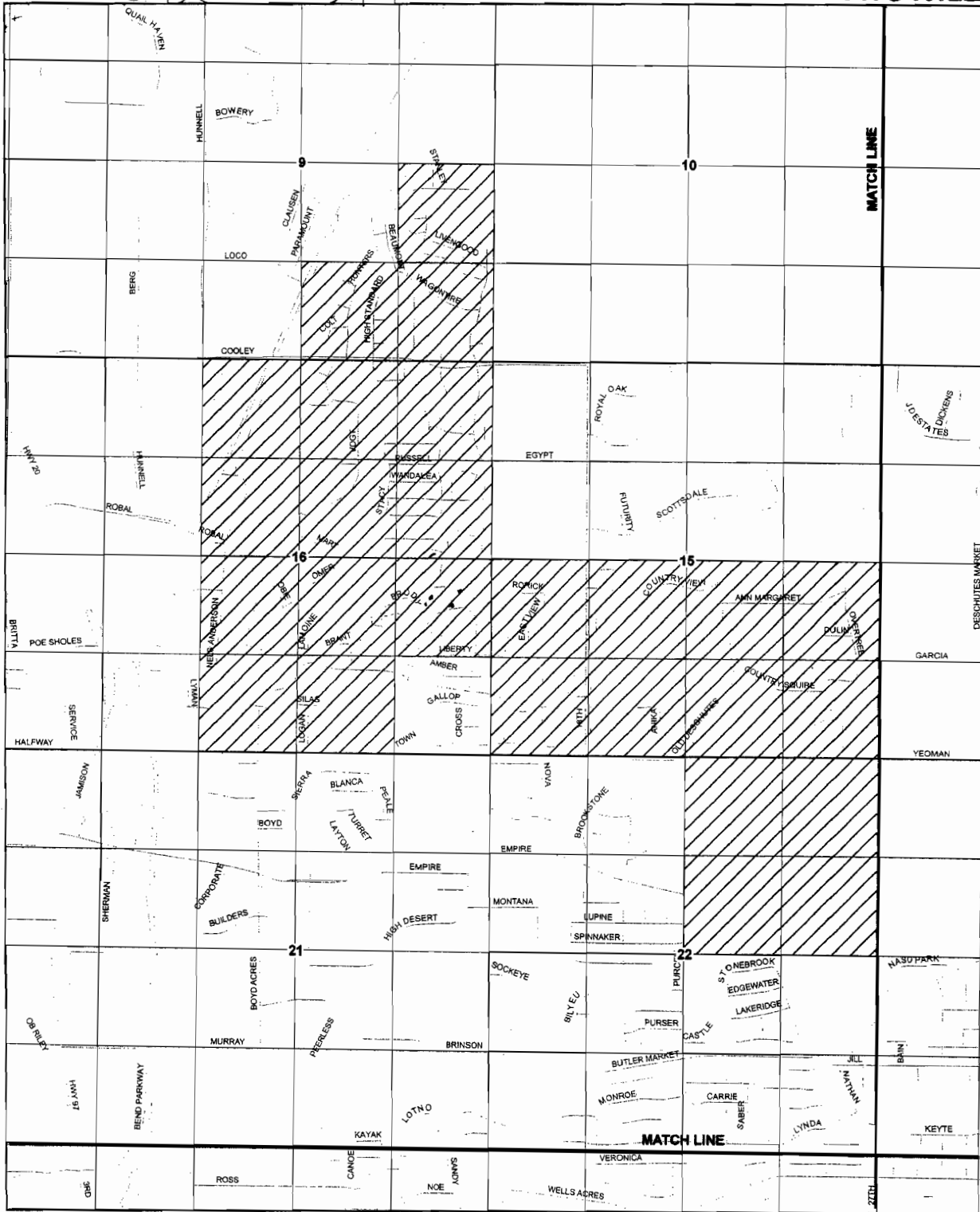

1 inch equals 1,320 feet

0 500 1,000 2,000 Feet

DRAWN BY: TANNER LEMMON
AVION WATER GIS DEPARTMENT
CWRE: TERRY SPRECHER
JUNE, 2006

PERMIT G-9975



DISCLAIMER:
This map was prepared for the purpose of identifying the location of water rights only and is not intended to provide legal dimensions or locations of property ownership lines.

NOTES:
- Please refer to "Attachment 1" for location of Distribution Piping
- Please refer to "Attachment 2" for Point of Appropriation locations



1 of 6

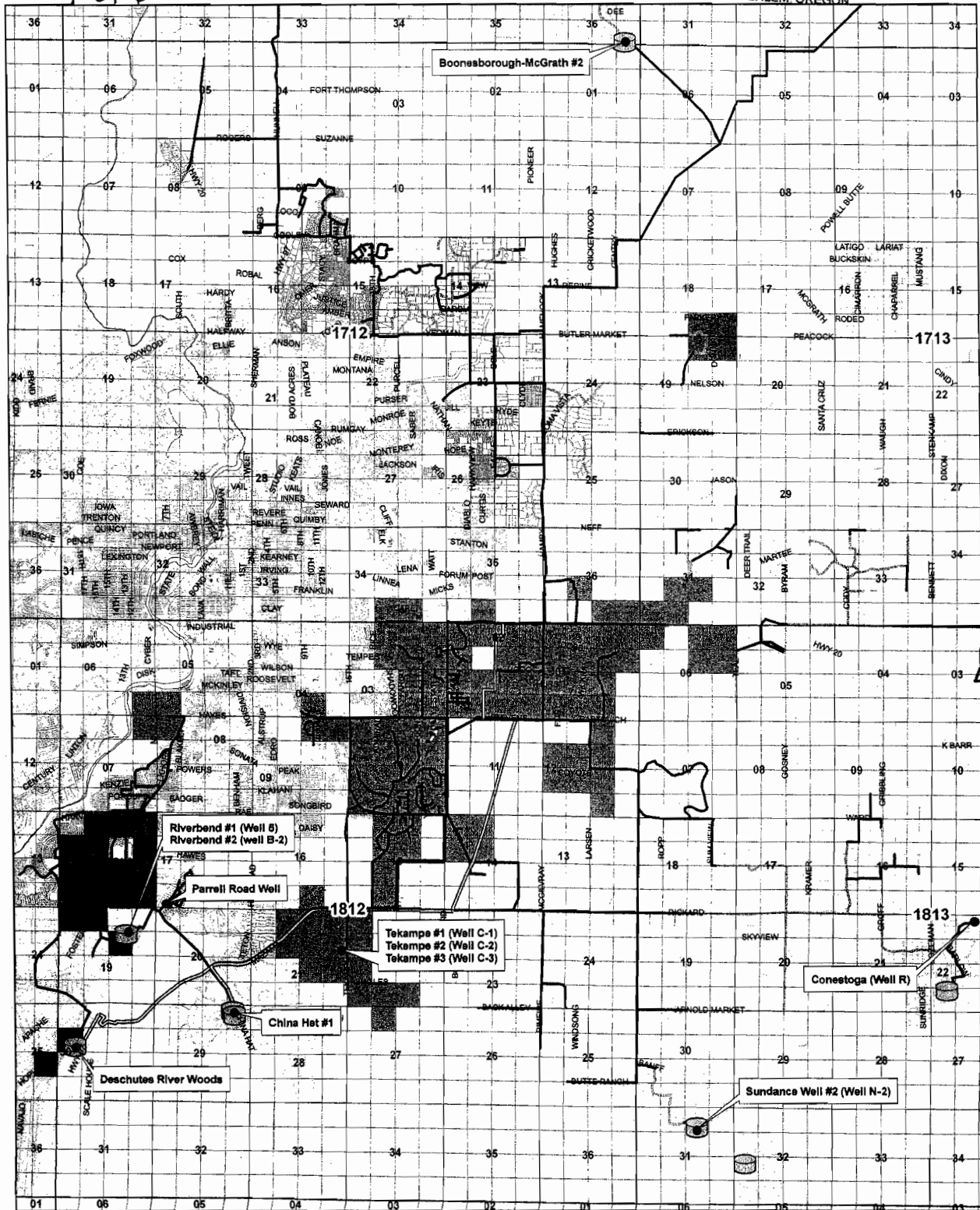

1 inch equals 5,280 feet

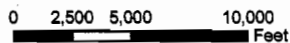

DRAWN BY: TANNER LEMMON
AVION WATER GIS DEPARTMENT
JUNE, 2006

PLACE OF USE

	PERMIT (G-9217)		PERMIT (G-9948)
	PERMIT (G-9289)		PERMIT (G-9975)
	PERMIT (G-9320)		PERMIT (G-9976)
	PERMIT (G-9946)		

DISCLAIMER:

This map was prepared for the purpose of identifying the location of water rights only and is not intended to provide legal dimensions or locations of property ownership lines.

	24-dom		12-dom		4-dom
	20-dom		10-dom		3-dom
	18-dom		8-dom		2-dom
	16-dom		6-dom		
	14-dom		5-dom		
	Points of Appropriation		Storage		