

T. 7S., R. 3W., W.M.

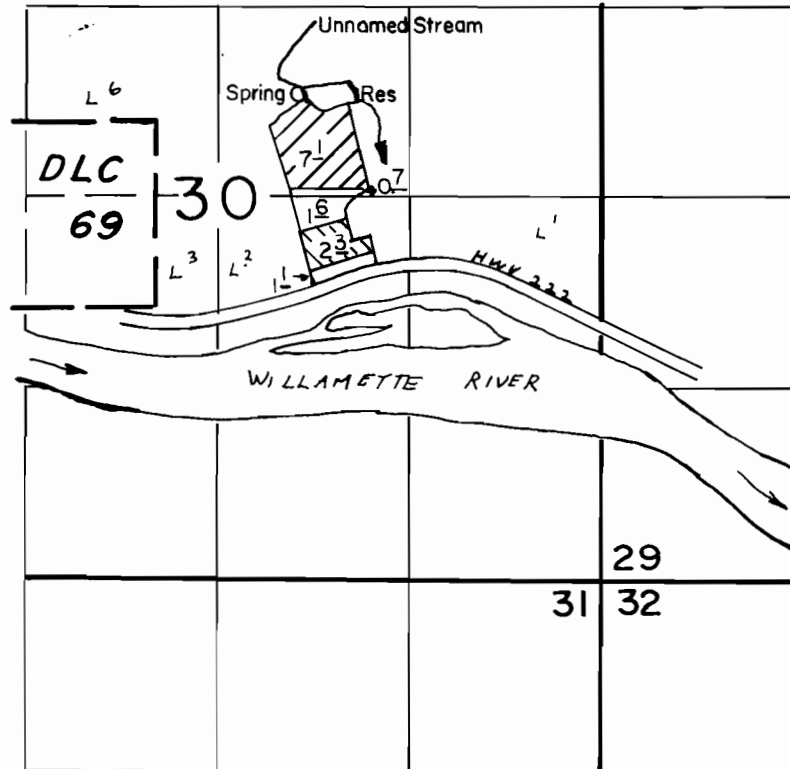

Div.-Pt. Loc. 650' N 81650' W., Spring Loc. 700' N 82070' W., Both From
E 1/4 Corner Section 30

SCALE: 1"=1320'

FINAL PROOF SURVEY UNDER

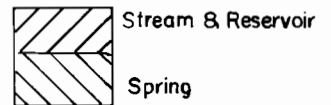

R- 65132 R- 8659
 Application No. 65133.... Permit No. 47565.....
 IN NAME OF

..ROBERT J. & BETTY M. KELLY.....

Surveyed MAY 4..... 1987., by B.W. BISHOP.....