

T.5S.,R.2W.,W.M.

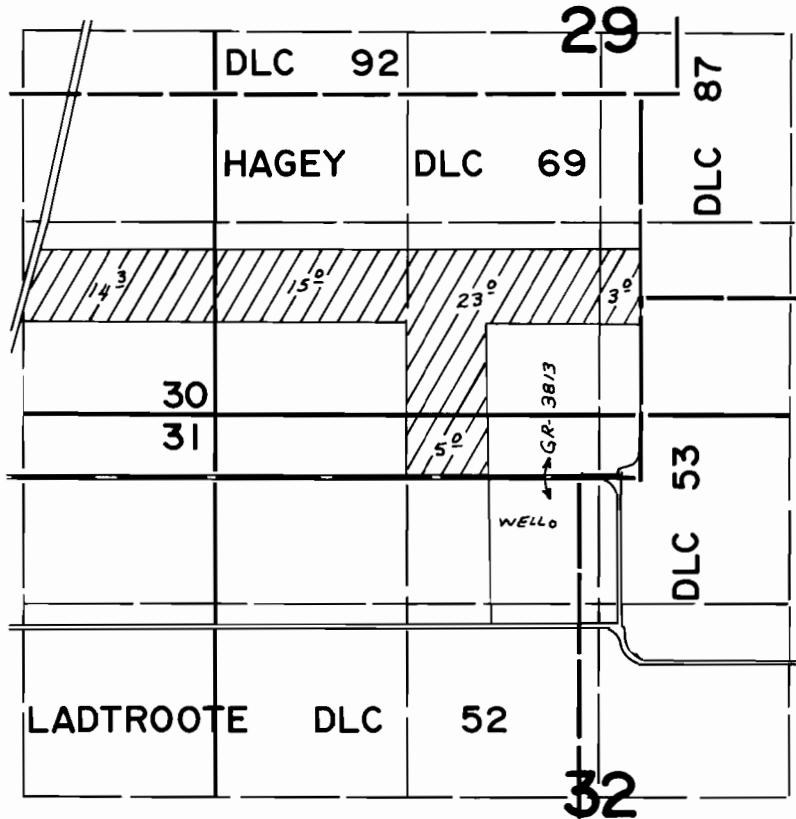

WELL LOC: 720'S AND 320' W FROM N 1/4 COR. SEC. 32

FINAL PROOF SURVEY UNDER

Application No. G-6849 Permit No. G-6335
IN NAME OF

ROGER R. WELTY

Surveyed April 2 1976, by L. Toll