

RECEIVED

JUL 6 - 1998

WATER RESOURCES DEPT.
SALEM, OREGON

T. 6 N., R. 35 E., W.M.

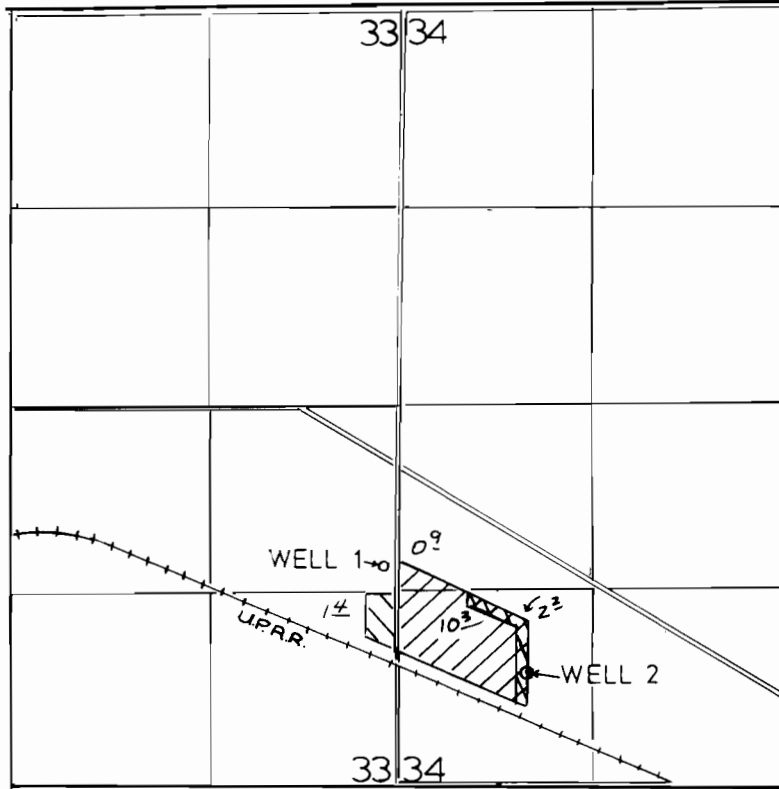

1" = 1320'

WELL 1 1540' N. & 90' W. FROM SE COR. SEC. 33.
WELL 2 800' N. & 920' E. FROM SW COR. SEC. 34.



PRIMARY IRR. WELL 1



SUPPLEMENTAL IRR. WELL 2.



SUPPLEMENTAL IRR. WELL 2.

FINAL PROOF SURVEY

UNDER

Application No. G-11359 Permit No. G-10496
IN NAME OF

GREENWOOD PACIFIC INC.

Surveyed April 26, 1994, by J. Miller