

TOWNSHIP 4 NORTH, RANGE 29 EAST, W.M.

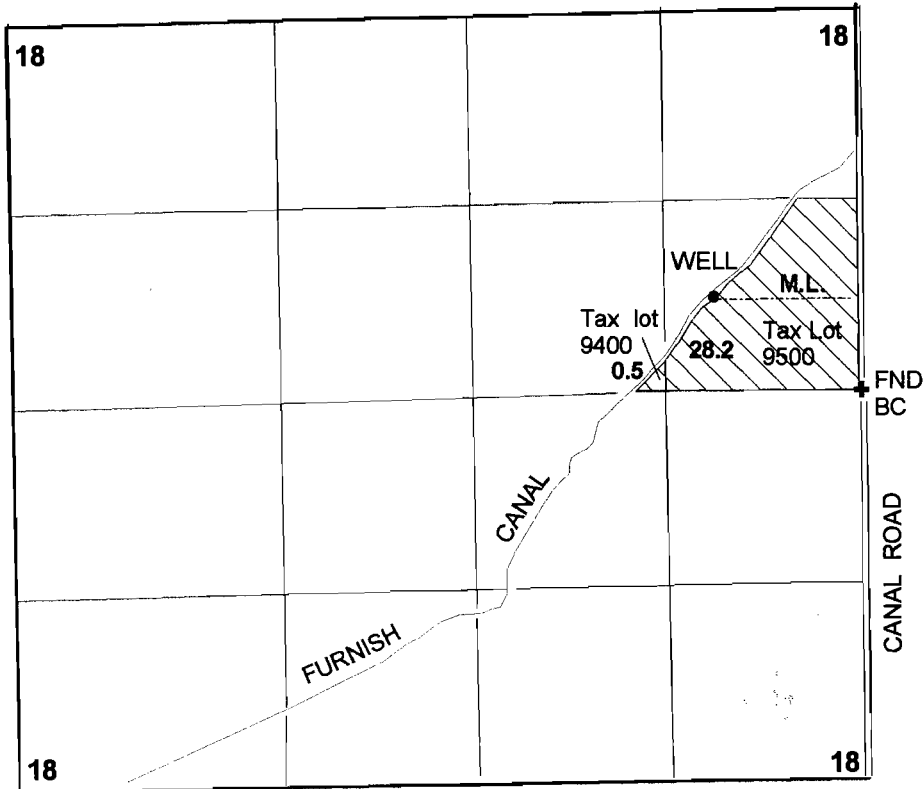

WELL - 640' NORTH AND 1010' WEST FROM THE EAST
QUARTER CORNER OF SECTION 18.

FINAL PROOF SURVEY

UNDER

Application G-11237 Permit G-10374

IN THE NAME OF

JOHNNIE M. MAYES

Surveyed : May 7, 2002 by: J. Miller

RECEIVED

APR 03 2003

WATER RESOURCES DEPT.
SALEM, OREGON

NZ-1MM-226 JM 12/23/2002