

T. 12 S., R. 45 E., W.M.

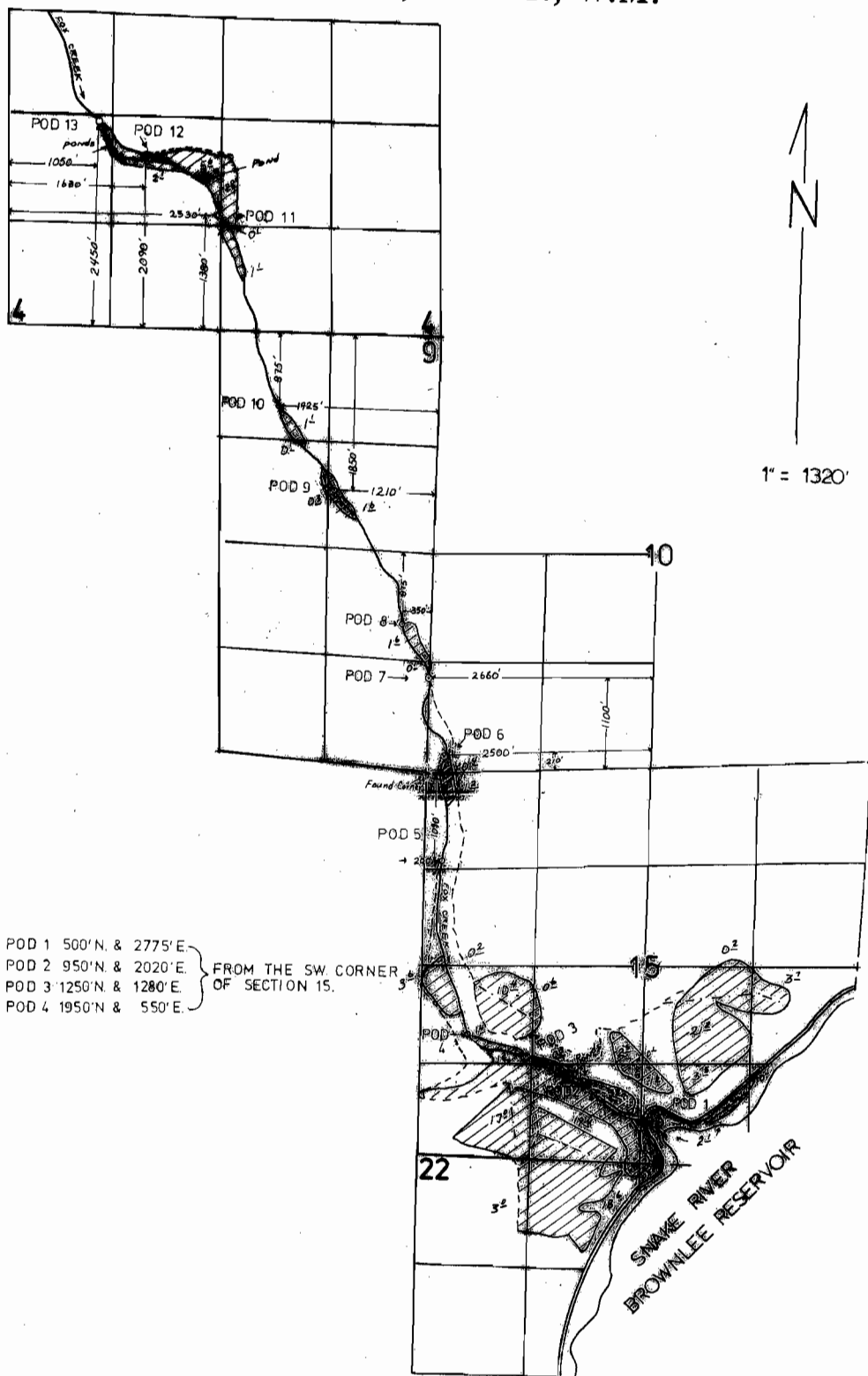

POD 1 500'N. & 2775'E.
 POD 2 950'N. & 2020'E.
 POD 3 1250'N. & 1280'E.
 POD 4 1950'N. & 550'E.

FROM THE SW CORNER
 OF SECTION 15.

FINAL PROOF SURVEY
 UNDER

Application No. 60168 Permit No. 46322
 IN NAME OF

WILERID DAWES DAVIS

Surveyed August 4, 1994, by L. Miller