

# T. 33 S., R. 7 1/2 E., W.M.

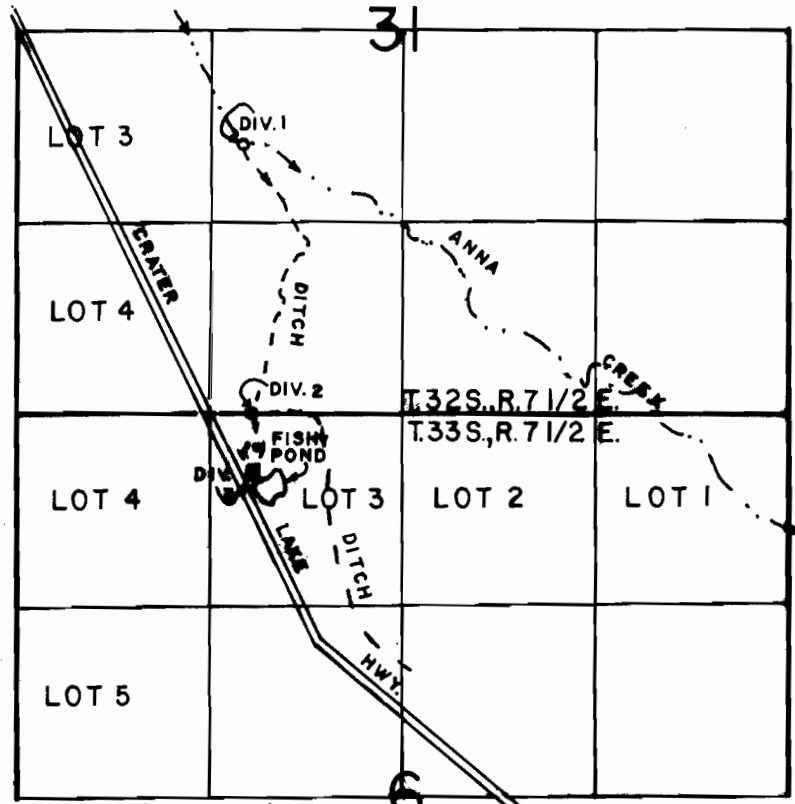

DIV.1 1850'N & 1550' E FROM SW COR. OF SEC. 31.  
DIV.2 10' N & 1600' E FROM SW COR. OF SEC. 31.  
DIV.3 480' S & 1600' E FROM NW COR. OF SEC. 6.

SCALE: 1" = 1320'

## FINAL PROOF SURVEY

UNDER

Application No. 61144 Permit No. 46399  
R-61143 R-8342  
IN NAME OF

LEO J. AND DOROTHY M. GYSIN

Surveyed MAY 14, 1991, by B.W.BISHOP