

# T. 33 S., R. 7 1/2 E., W.M.

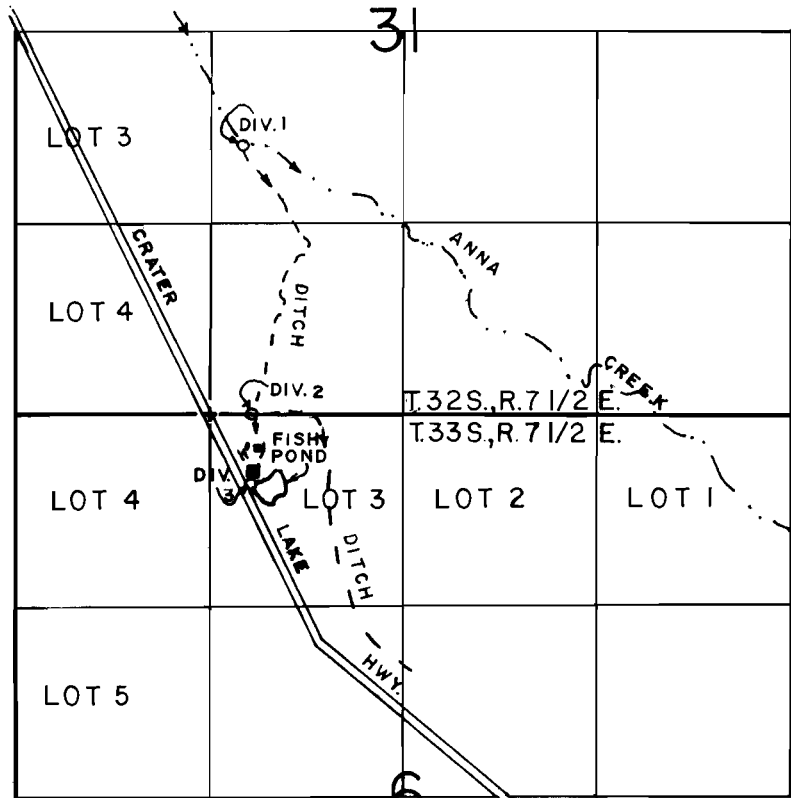

DIV.1 1850'N & 1550'E FROM SW COR. OF SEC 31.  
 DIV.2 10'N & 1600'E FROM SW COR. OF SEC 31.  
 DIV.3 480'S & 1600'E FROM NW COR. OF SEC 6.

SCALE: 1" = 1320'

## FINAL PROOF SURVEY

UNDER

Application No. **61144** Permit No. **46399**  
 R-61143 R-8342  
 IN NAME OF

LEO J. AND DOROTHY M. GYSIN

Surveyed MAY 14, 1991, by B.W.BISHOP