

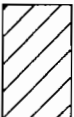

TOWNSHIP 15 SOUTH, RANGE 46 EAST, W.M.

-  PRIMARY P # G-7150
SUPPLM P # 41397 (POD # 2)
-  PRIMARY P # 41397 (POD # 1)
-  PRIMARY P # G-7150
SUPPLM P # 41397
(POD # 1 OR # 2)

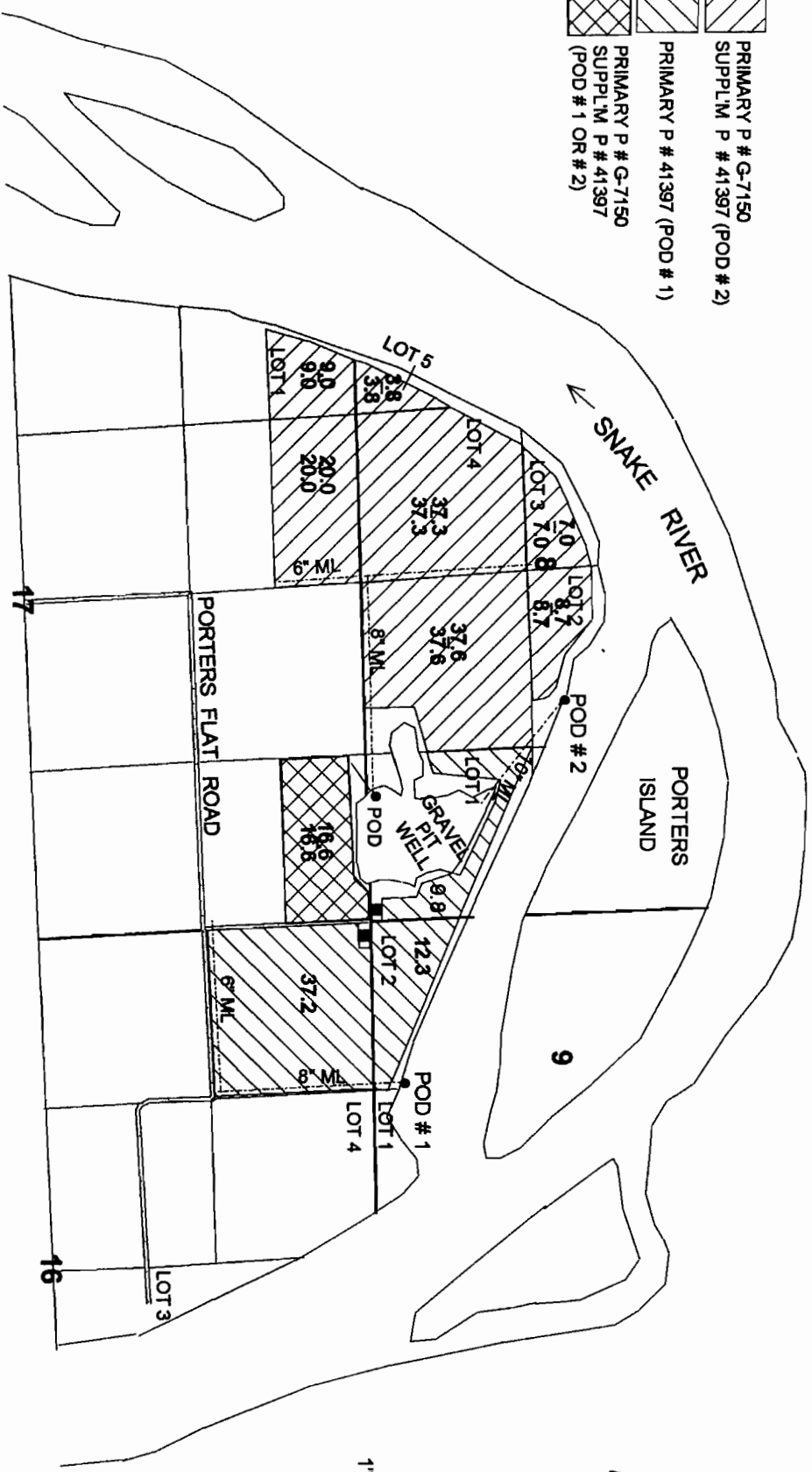

POD # 1 - SNAKE RIVER DIVERSION - 230' NORTH AND 1280' EAST OF THE SW CORNER, SECTION 9.
 POD # 2 - SNAKE RIVER DIVERSION - 1570' NORTH AND 1680' WEST OF THE SE CORNER, SECTION 8.
 POD - GRAVEL PIT WELL - 70' NORTH AND 900' WEST OF THE SE CORNER, SECTION 8.

FINAL PROOF SURVEY
 UNDER
 Application No. 55149 Permit No. 41397
 G-7658 G-7150
 IN THE NAME OF

Surveyed: July 31, 2002 by: J. Miller

RECEIVED
 APR 03 2003
 WATER RESOURCES DEPT.
 SALEM, OREGON