

T. 25 S., R. 30 E., W.M.

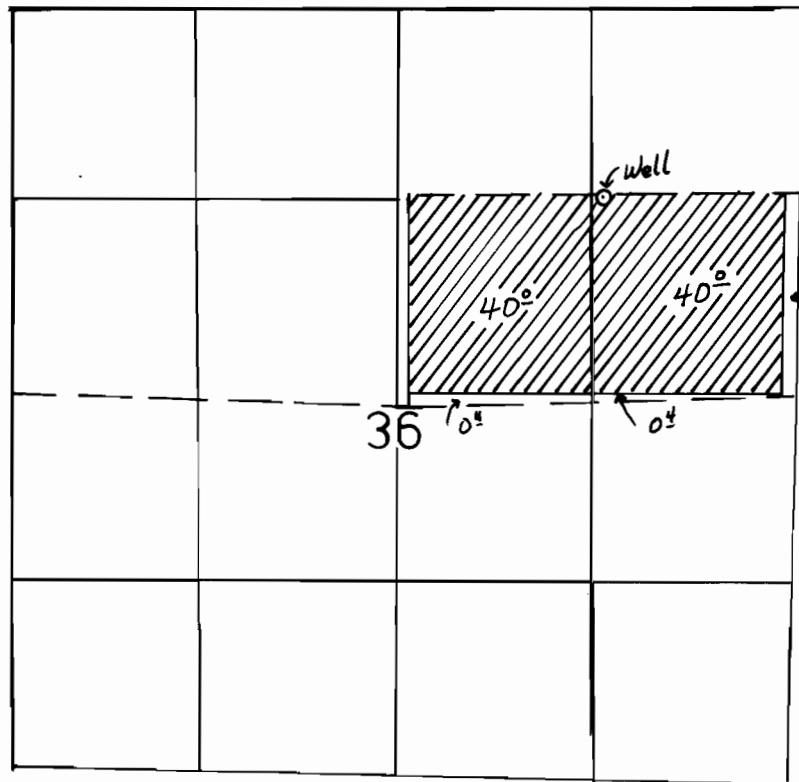
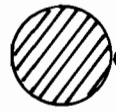
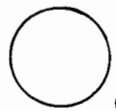

1" = 1320'

-  irrigated acres applied for
-  irrigated acres not applied for

WELL LOCATED 1320' S. & 1350' W. from the NE Corner Section 36.

FINAL PROOF SURVEY

UNDER

Application No. G-10977 Permit No. G-10106
IN NAME OF

GLEN CHOWNING

Surveyed 10-30, 1990, by K. KEMP