

9179
8261

T. 33 S. R. 6 E. M.W.

T. 33 S. R. 7 1/2 E. M.W.

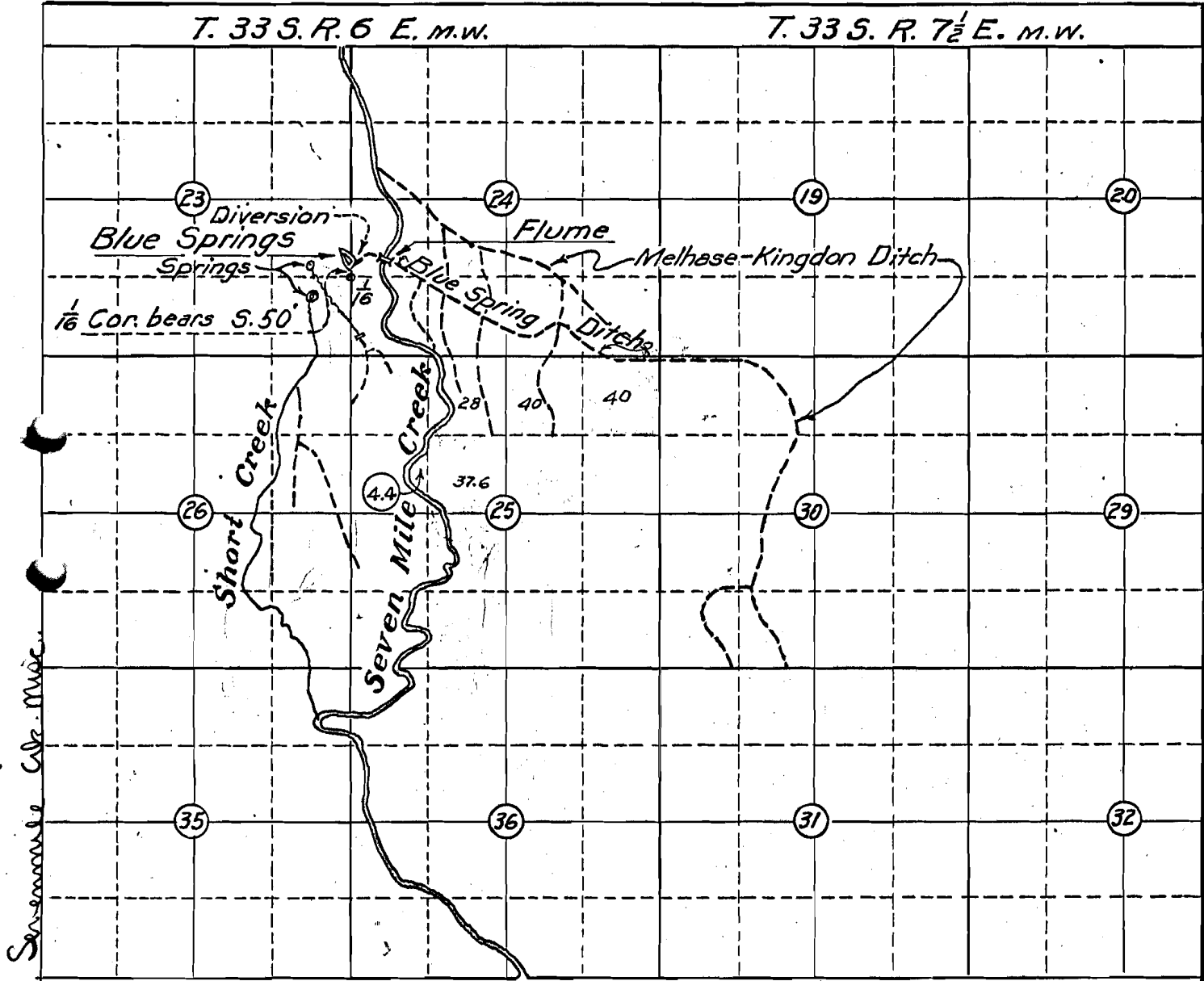

MAP

Accompanying application for appropriation of water from Blue Springs to supplement water right of S.C. Miller on Seven Mile Creek thru Melhase-Ditch, Klamath County, Oregon, Kingdon Scale: 2 in. = 1 mile.

Engineer's Certificate:

I, C.C. Kelley, of Klamath Falls, Oregon, do hereby certify that this map was made from notes taken during an actual survey made under my immediate supervision on the 24th day of July, 1928, and that it correctly represents the works described in the accompanying application, together with the location of streams and other ditches in the immediate vicinity

Application No. 12343
Permit No. 9179

C.C. Kelley

Registered Professional Engineer
Oregon No. 308