

T. 19 S., R. 37 E., W.M.

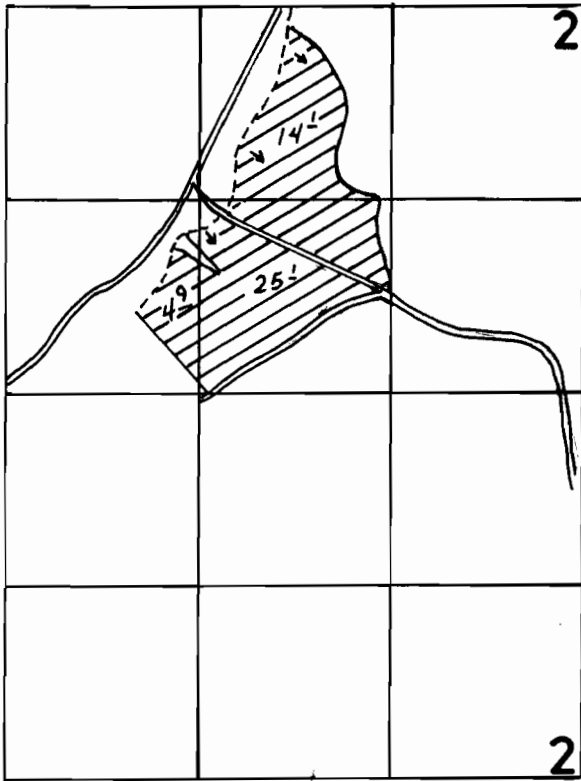

MURPHY RESERVOIR POD
T. 18 S., R. 38 E.

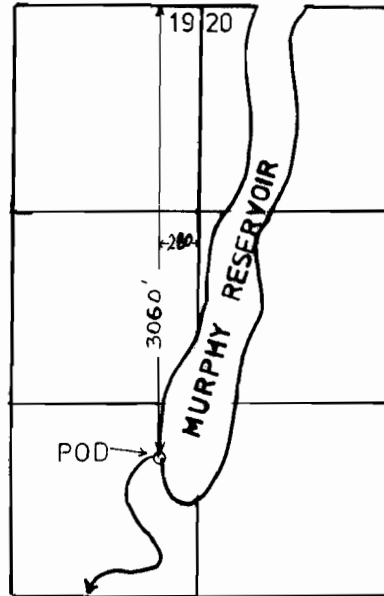

BENDIRE CREEK POD
T. 18 S., R. 37 E., NE 1/4 SEC. 36

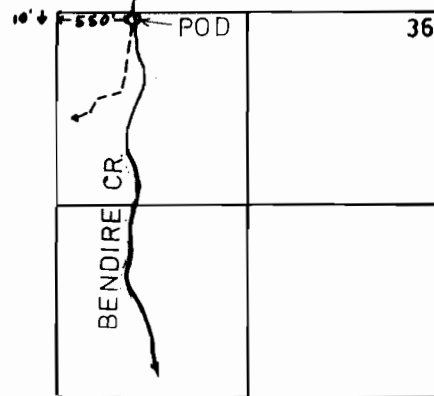

SCALE 1" = 1320'

FINAL PROOF SURVEY UNDER

Application No. 68932 Permit No. 49947
IN NAME OF

WILLIAM J. BUTLER

Surveyed JULY 6, 1994, by J. MILLER