

T5N, R28E, W.M.,
UMATILLA COUNTY, OREGON
FINAL PROOF SURVEY

Application No. G-12502
Permit No. G-11281

IN THE NAME OF:

Arne H. Pihl
P.O. Box 9
Sprague, Washington 99032
Phone: 509-235-4646

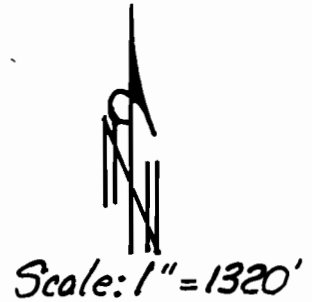
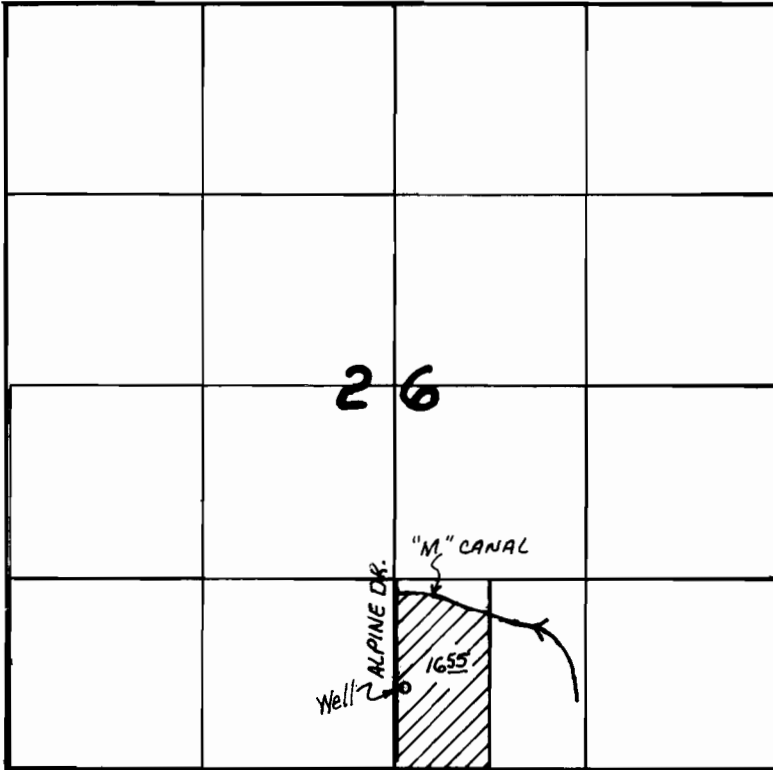

Well lies 560' N. & 60' E. of S¹/₄ of Section 26.

This map is for identifying the location of water rights only and is not intended to show property lines or dimensions.

G. Dennis Edwards

Edwards Surveying P.O. Box 763
567-3336 Hermiston, OR. 97838
1/24/94 Job #W9103014-A