

T. 31 S., R. 10 E., W.M.

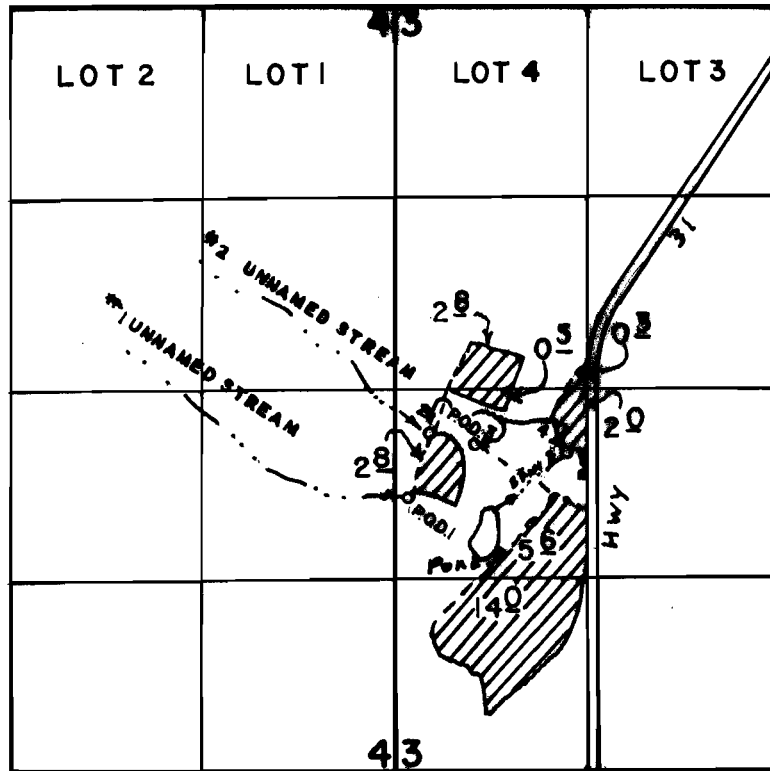

P.O.D. 1, 1900' N & 100' E. P.O.D. 2, 2350' N & 230' E.
P.O.D. 3, 2250' N & 550' E. P.O.D. 4, 2200' N &
1190' E ALL FROM SW COR. OF SEC 3.

SCALE: 1" = 1320'

FINAL PROOF SURVEY UNDER

Application No. 53739 Permit No. 41530
IN NAME OF

S. JEAN LOOSLEY

Surveyed APRIL 11, 1994 by R.M. SUTTERFIELD