

# T.8&9S.R.25E.W.M.

**RECEIVED**

JUN 19 1987  
 WATER RESOURCES DEP.  
 SALEM, OREGON

T-5961

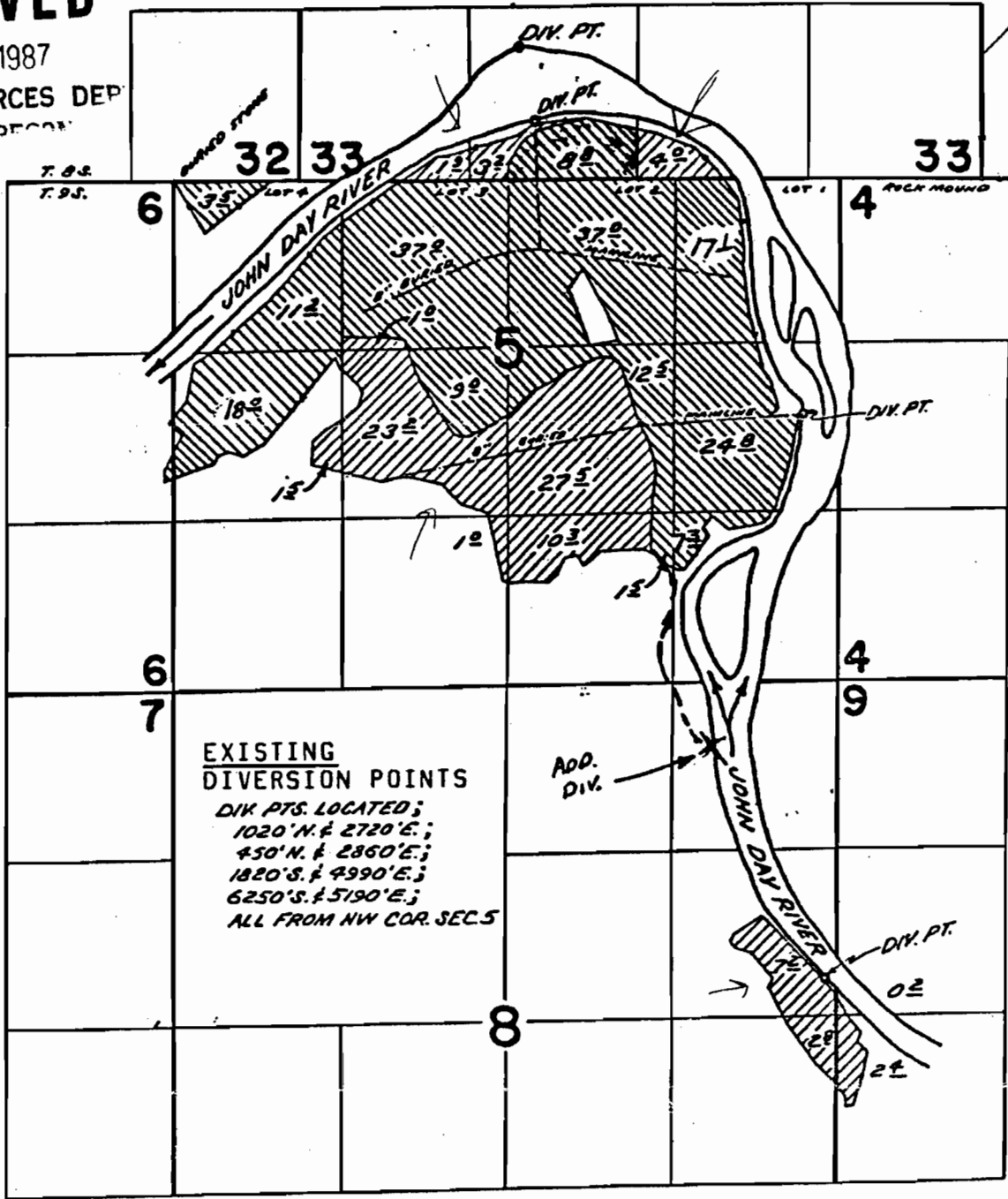

**EXISTING  
 DIVERSION POINTS**  
 DIV PTS. LOCATED;  
 1020' N. & 2720' E.;  
 450' N. & 2860' E.;  
 1820' S. & 4990' E.;  
 6250' S. & 5190' E.;  
 ALL FROM NW COR. SEC. 5

Certificate 52096 & 52098  
 Certificate 36654

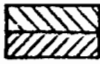

4" = 1Mi.

ADDITIONAL DIVERSION POINT LOCATION; 500'S & 1000'W from NE cor. Sec. 8