

# T. 30S., R. 9E., W.M.

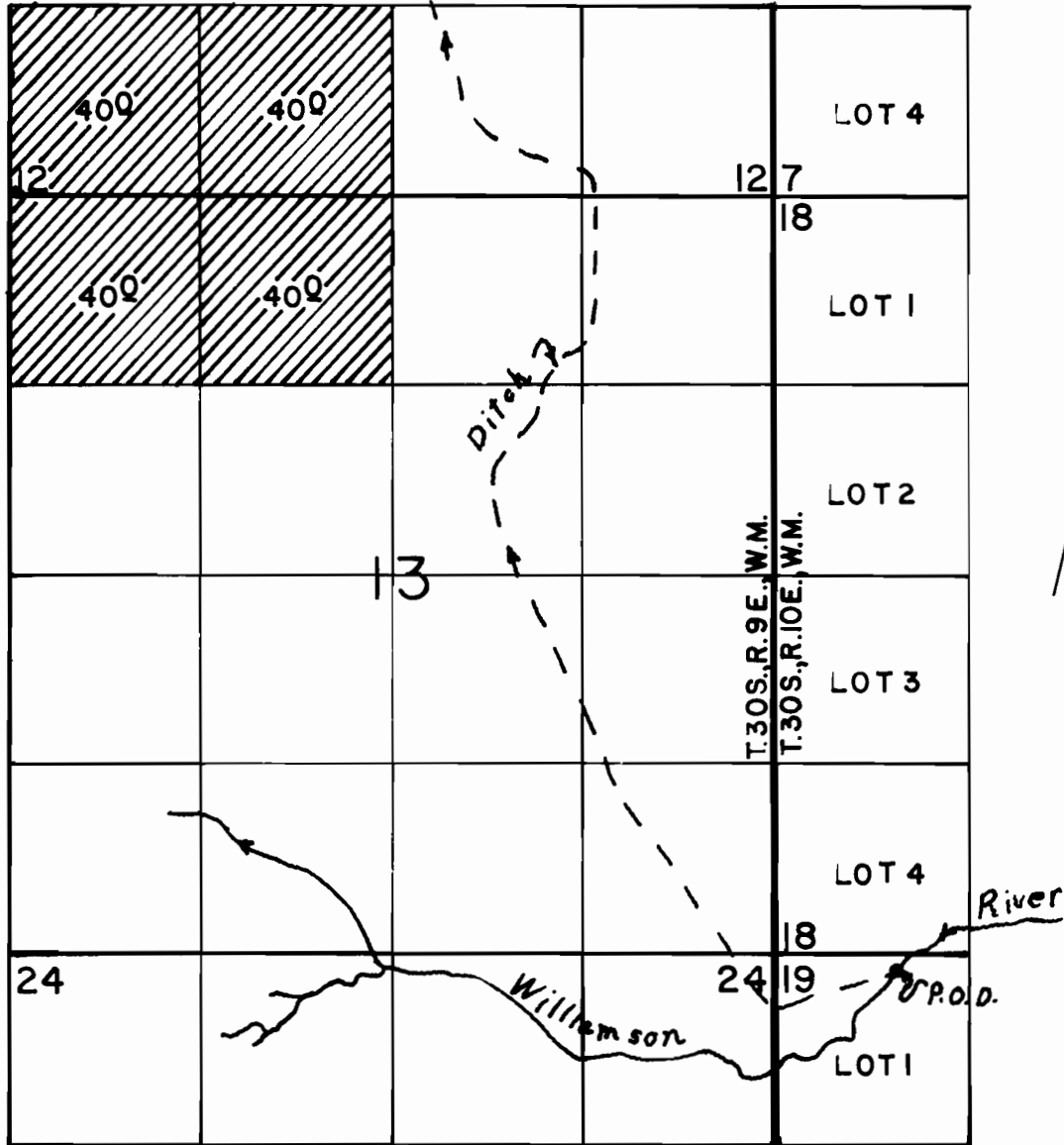

P.O.D. LOC: 160' S & 800' E FROM NW COR. OF SEC 19. IN R. 10E.

SCALE: 1" = 1320'

## FINAL PROOF SURVEY

UNDER

Application No. 58916 Permit No. 44427  
IN NAME OF

JOHN C. HORTON

Surveyed MAY 27, 1994, by R.M. SUTTERFIELD