

T. 8 S., R. 24 E., W.M.

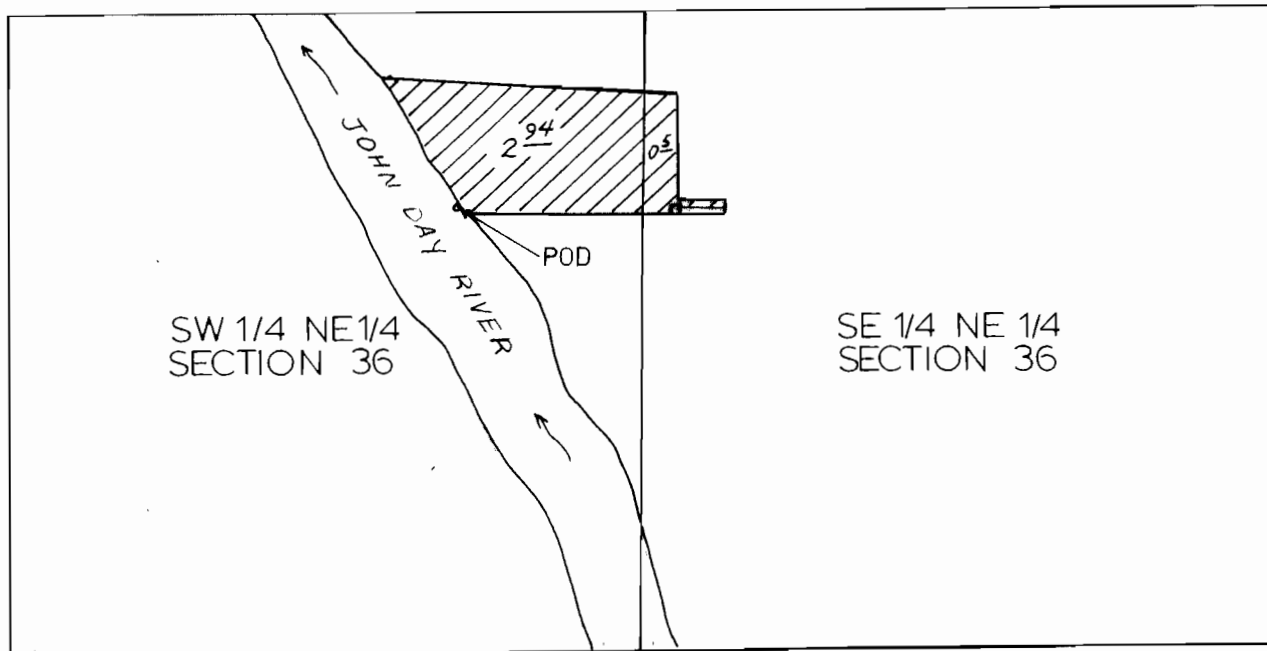

POD - 1750' S. AND 1650' WEST FROM THE N.E. CORNER OF SECTION 36.



FINAL PROOF SURVEY UNDER

Application No. 69162 Permit No. 50235
IN NAME OF

ROBERT ASHMEAD

Surveyed 11-12, 1992, by J. MILLER

1" = 400'