

T.28,29S.,R.5W.,W.M.

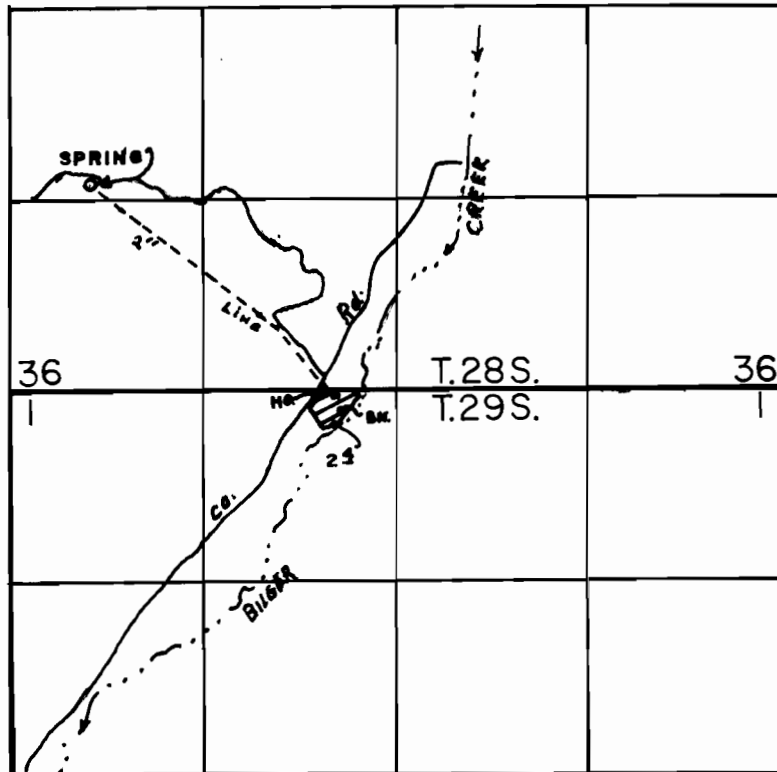

SPRING LOC: 1420' N & 535' E FROM SW COR. OF SEC 36.

SCALE: 1" = 1320'

FINAL PROOF SURVEY UNDER

Application No. 57891. Permit No. 43684....
IN NAME OF

.....BERT VALDEZ.....

Surveyed JUNE 3, 19.97, by R.M. SUTTERFIELD