

T12S, R26E, WM

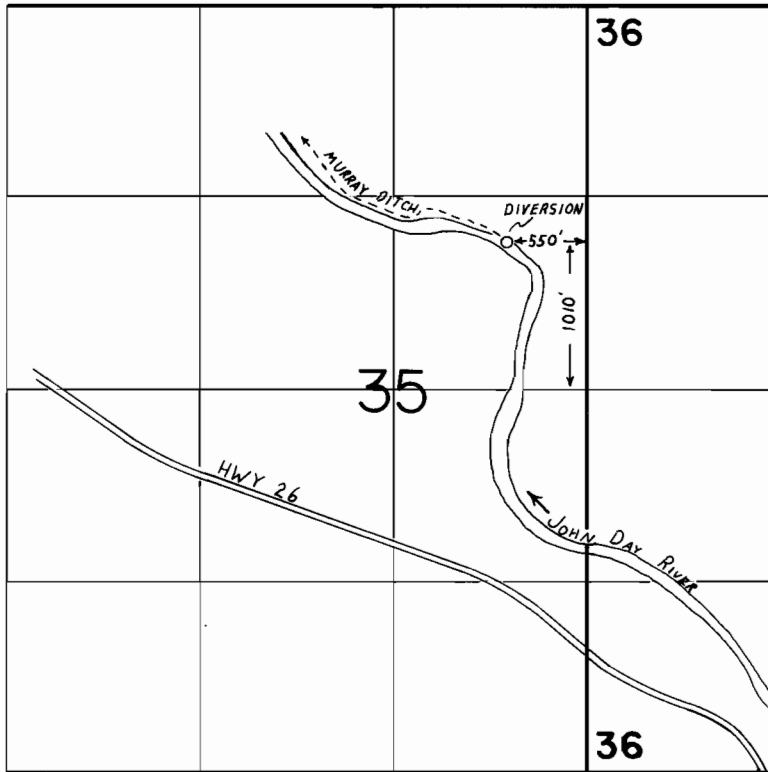

FINAL PROOF SURVEY UNDER

Transfer No.5962...
 Application No. Permit No.
 IN NAME OF

.....JERALD F. CLAUSEN.....

Surveyed JUNE...16. 1988., by T.M. WARREN

RWK
 41023 179 72L

RECEIVED

T. 12 S., R. 26 E., W.M.

JUN 22 1987

TRANSFER APPLICATION MAP FOR WATER RESOURCES DEPT.
SALEM, OREGON

JERALD F. CLAUSEN

T-5962



SCALE

4" = 1 mi

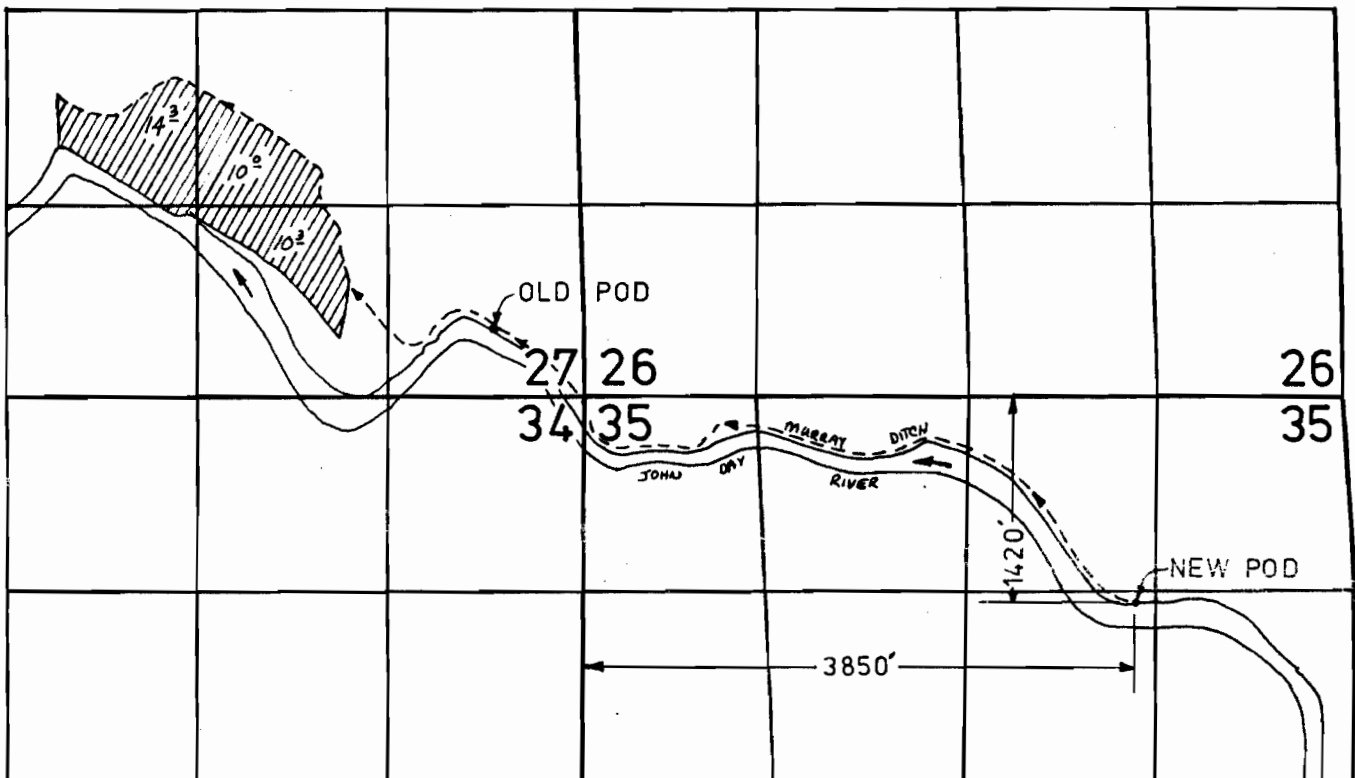

Old Div. - 450'N & 620'W from the
SE corner of Sec. 27