

T.30S., R.17E., W.M.

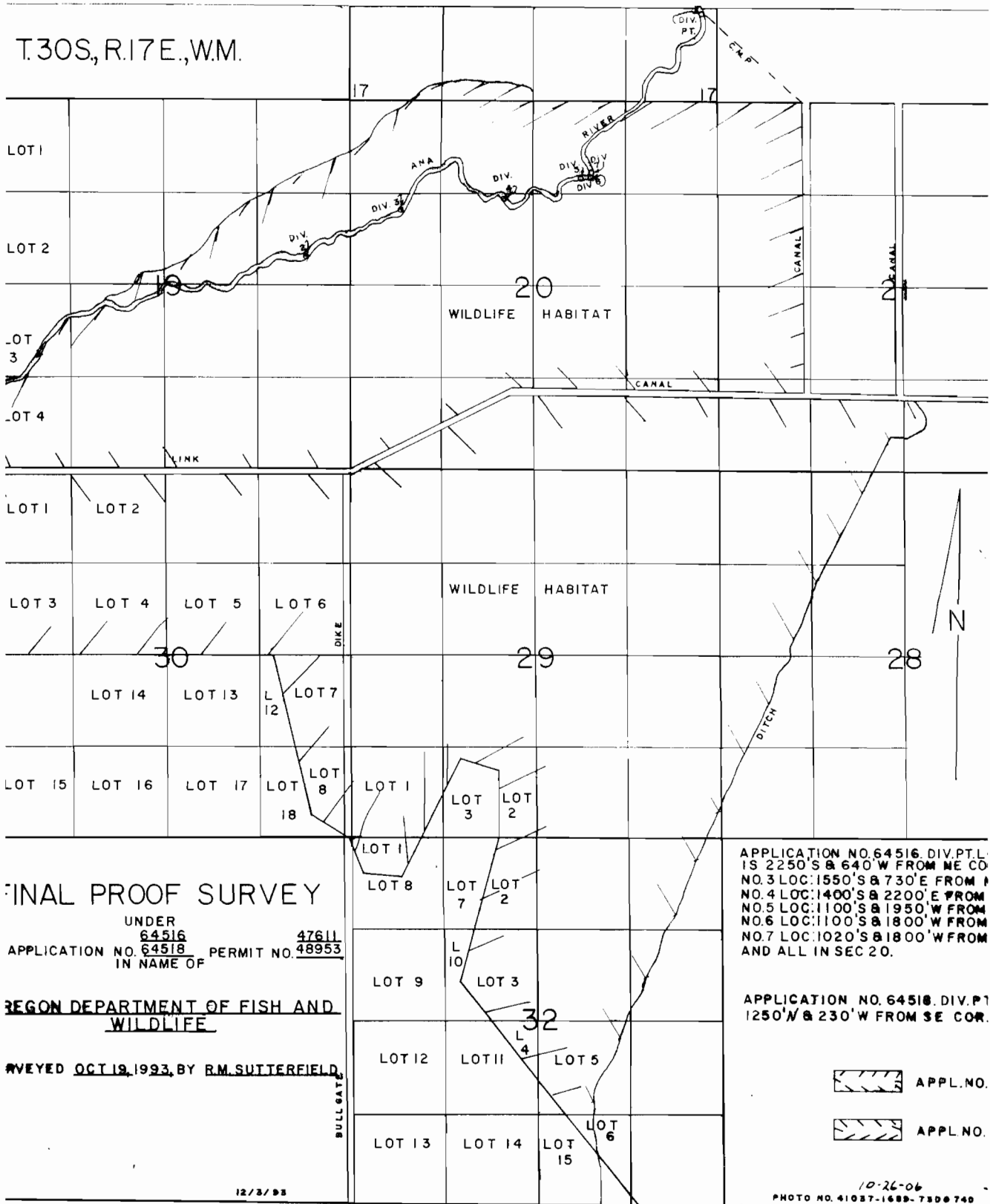

FINAL PROOF SURVEY

UNDER

64516

47611

APPLICATION NO. 64518

PERMIT NO. 48953

IN NAME OF

REGON DEPARTMENT OF FISH AND WILDLIFE

SURVEYED OCT 19, 1993, BY R.M. SUTTERFIELD

APPLICATION NO. 64516, DIV. P.T.L.
 1S 2250'S & 640' W FROM NE COR.
 NO. 3 LOC: 1550'S & 730' E FROM P
 NO. 4 LOC: 1400'S & 2200' E FROM
 NO. 5 LOC: 1100'S & 1950' W FROM
 NO. 6 LOC: 1100'S & 1800' W FROM
 NO. 7 LOC: 1020'S & 1800' W FROM
 AND ALL IN SEC 20.

APPLICATION NO. 64518, DIV. P.1
 1250' N & 230' W FROM SE COR.

 APPL. NO.

 APPL. NO.