

T. 34 S., R. 6 E., W.M.

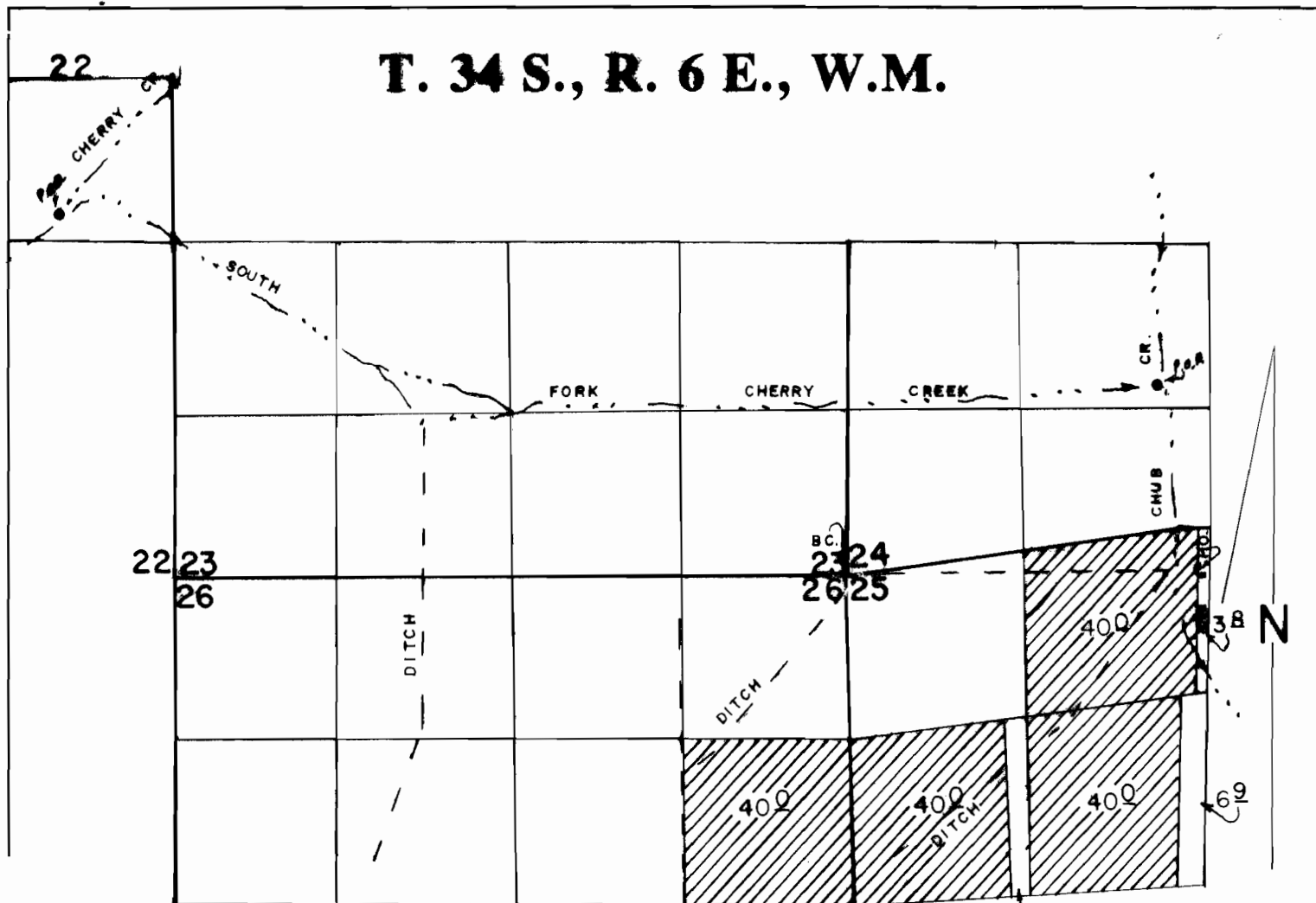

CHERRY CR. P.O.D. 2850' N & 910' W FROM SE COR. OF SEC 22.
CHUB CR. P.O.D. 1480' N & 2440' E FROM SW COR. OF SEC 24.

SCALE: 1" = 1320'

FINAL PROOF SURVEY
UNDER

Application No. 48311 Permit No. 36276
IN NAME OF

MARY JANE DANFORTH

Surveyed JUNE 20, 1994, by R.M. SUTTERFIELD