

T.40S.,R.17E.,W.M.

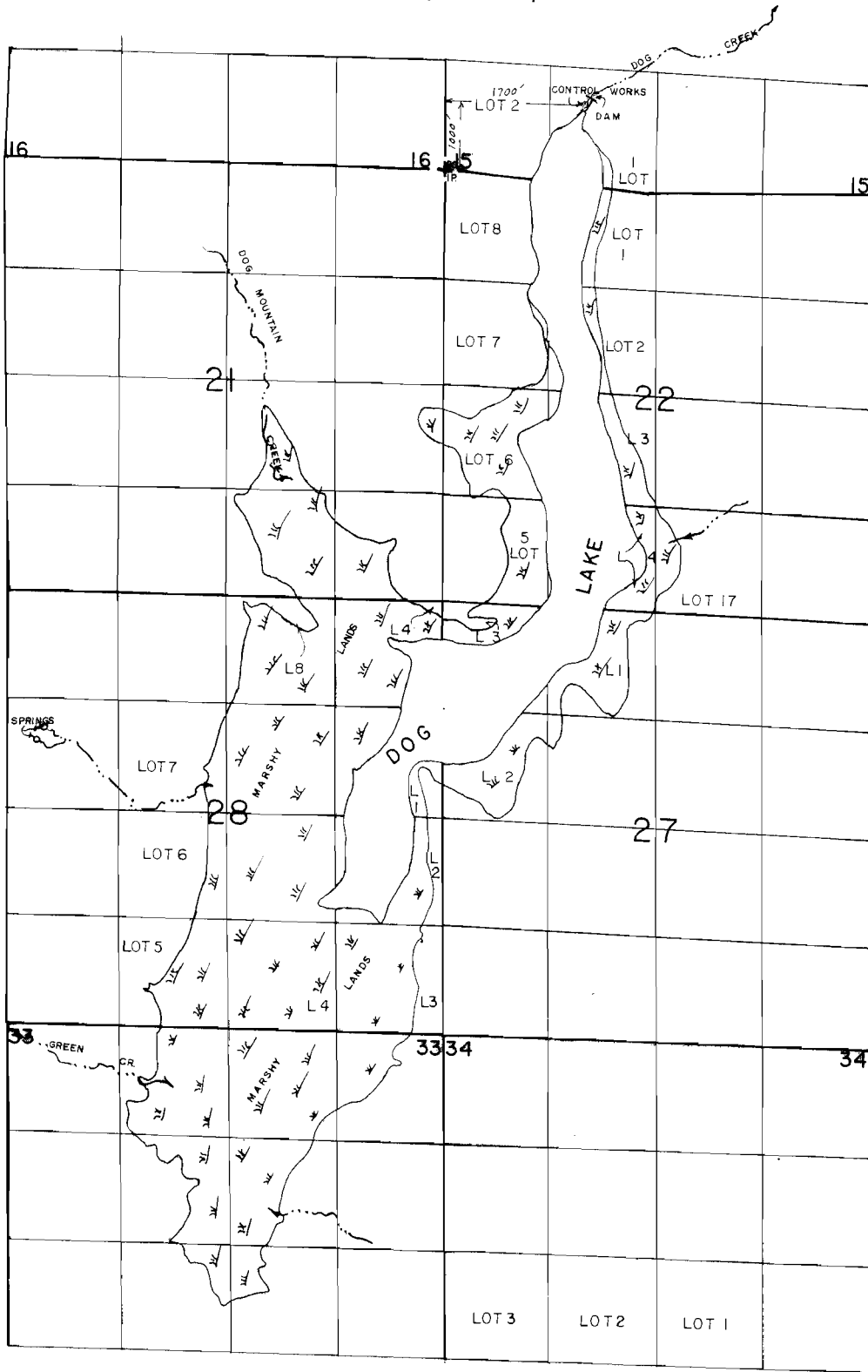

SCALE: 1"=1320'

FINAL PROOF SURVEY

UNDER

Application No. 61813 Permit No. 49677
R-61747 R-10626

IN NAME OF

UNITED STATES, FREMONT NAT. FOREST

SURVEYED AUG 16, 1990, by BWBISHOP

RECEIVED
MAY 20 1986
WATER RESOURCES DEPT
SALEM, OREGON

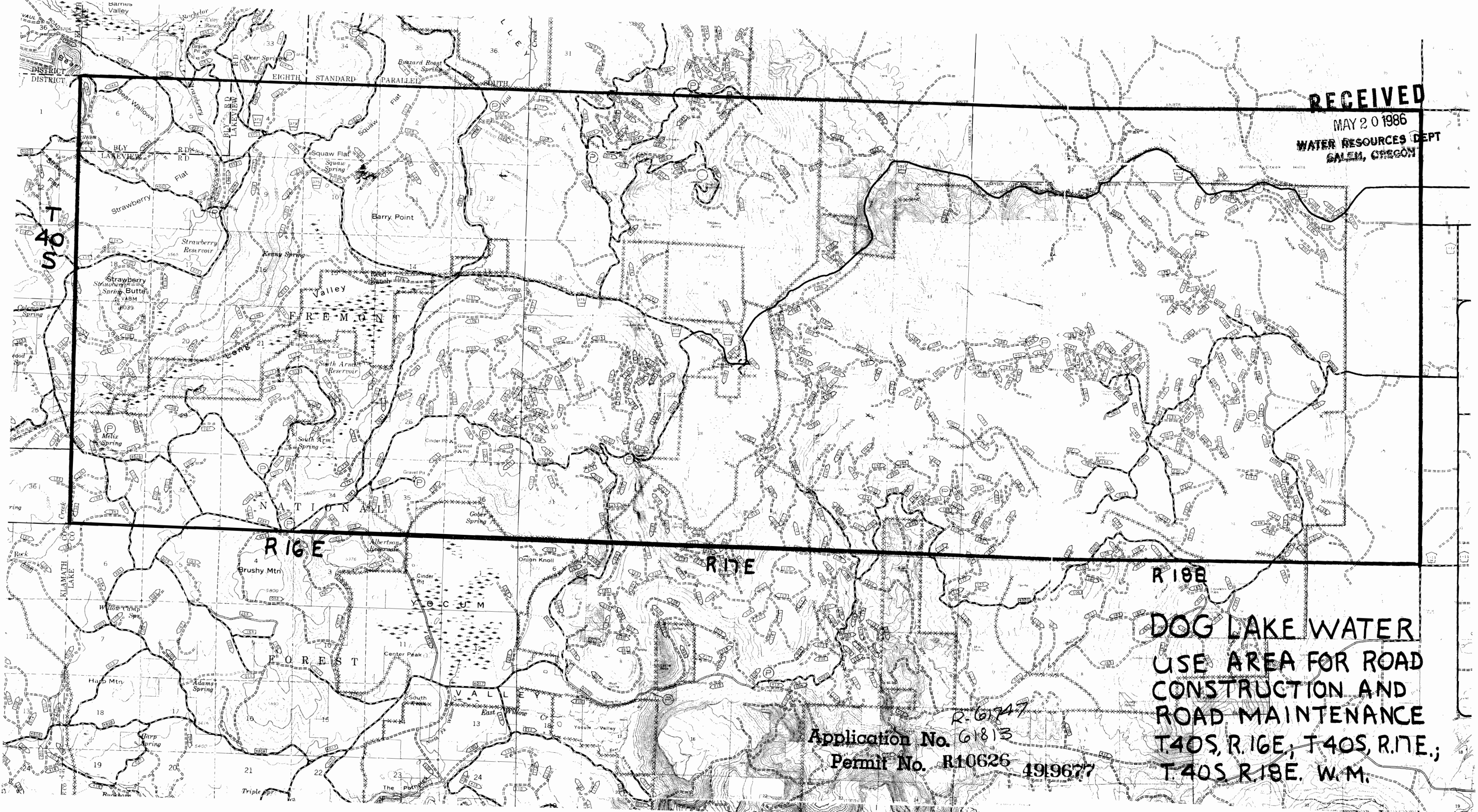

T
40
S

R
16
E

R
17
E

R
18
E

R-6247
Application No. 61813
Permit No. R10626 4919677

**DOG LAKE WATER
USE AREA FOR ROAD
CONSTRUCTION AND
ROAD MAINTENANCE
T.40S, R.16E, T.40S, R.17E.,
T.40S, R.18E. W.M.**