

T. 35 S., R. 10 E., W. M.

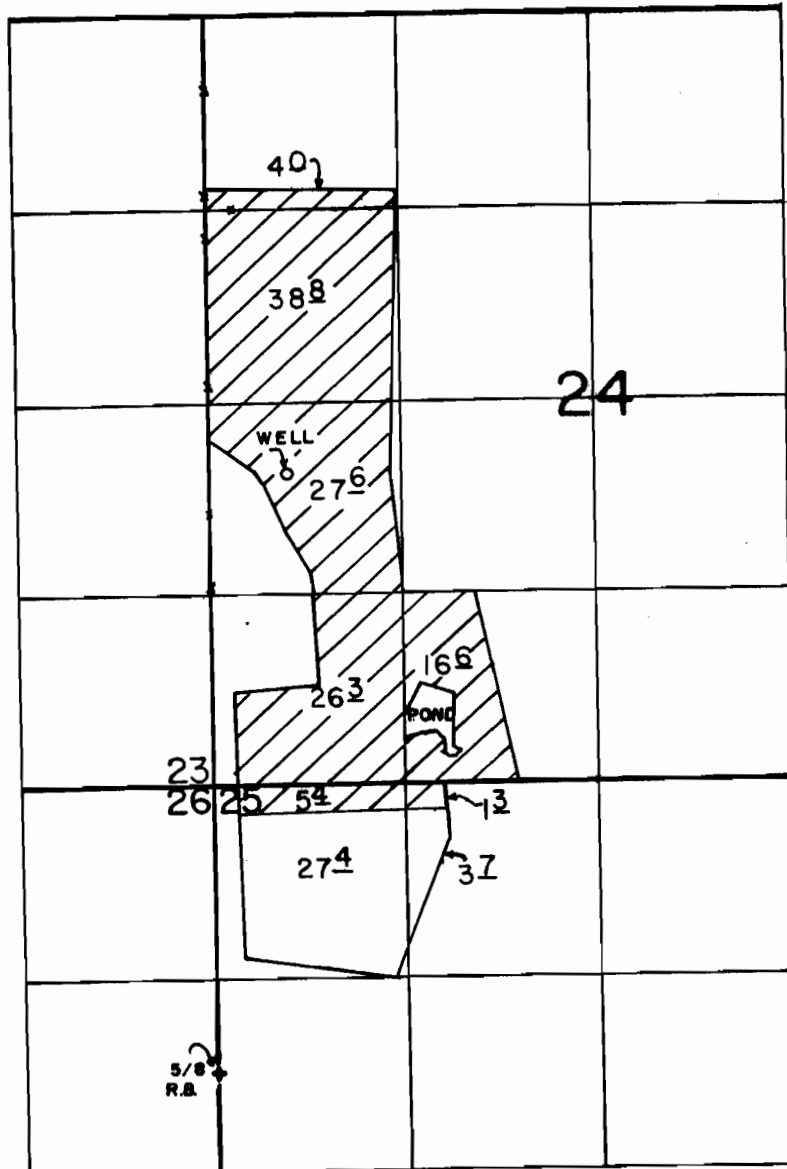

WELL LOC.: 2130' N. & 540' E. FROM SW COR. OF SEC 24.

**FINAL PROOF SURVEY
UNDER**

Application No. G-11069 Permit No. G-10344.
IN NAME OF

..... LOIS MCMILLAN SMITH

Surveyed AUG 27 1991, by B. W. BISHOP