

T. 7 & 8 N., R. 5 W., W.M.

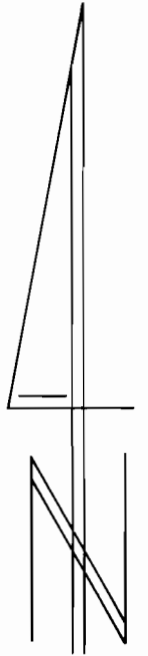
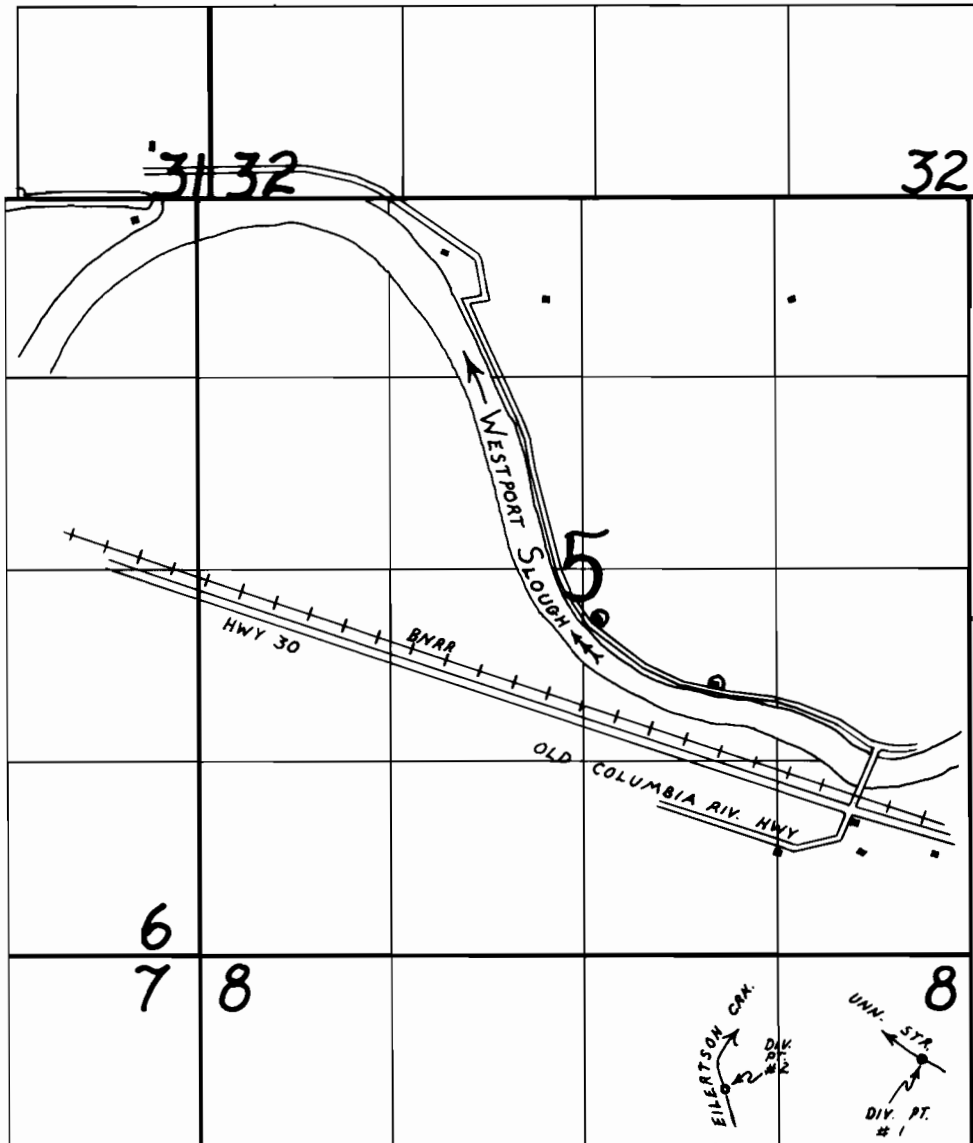

1" = 1320'

DIVERSION 1 - 720' S & 340' W; DIVERSION 2 - 920' S & 1700' W
BOTH LOCATED FROM THE NE CORNER SECTION 8

FINAL PROOF SURVEY

UNDER

Application No. 56849 Permit No. 44553
IN NAME OF

Westwood Water Association

Surveyed May 5, 1994, by R.W. Klassen

■ PRIMARY EILERTSON
SUPP. UNN. STR.

⊙ SUPP UNN. STR.