

# T. 8 S., R. 3 W., W.M.

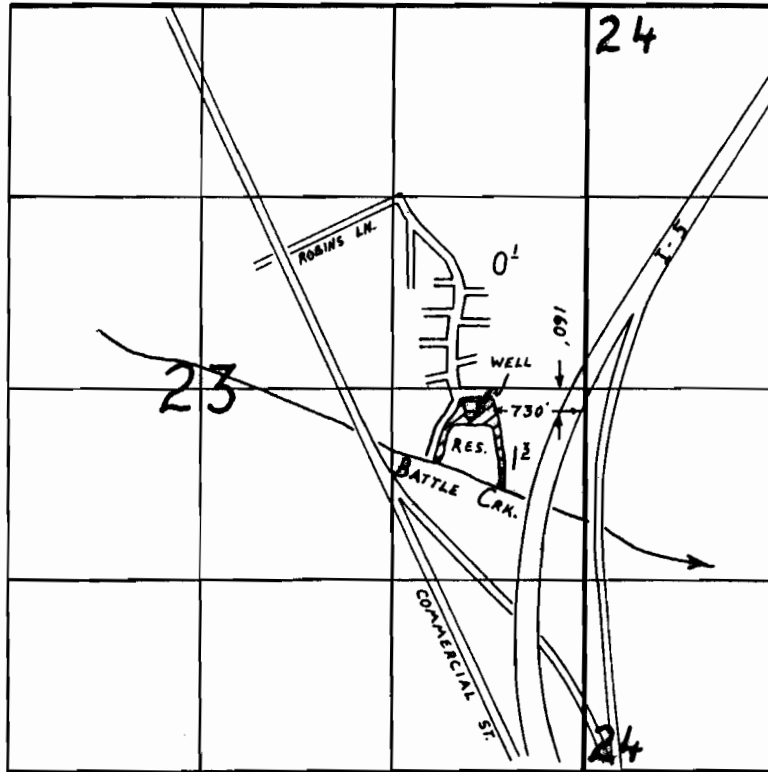

## FINAL PROOF SURVEY

UNDER

Application No. G-9103  
R-58231, 58240 Permit No. G-8792  
R-8098, 44724  
IN NAME OF

### TERRACE LAKE

Surveyed AUGUST 17, 1992, by R.W. Klassen

**WORK COPY**

**T. 8 S., R. 3 W., W.M.**

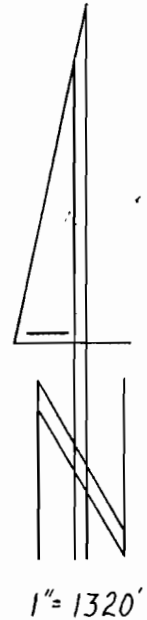
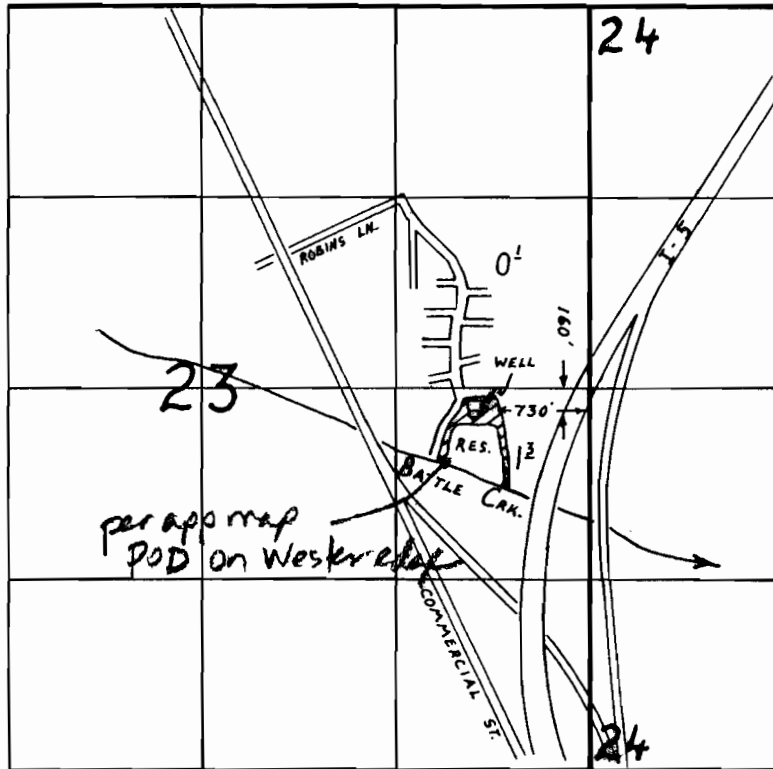

Reservoir POD = 500 feet South and 1000 feet West  
from NE CORNER, NESE, SEC 23  
(E/4 CORNER)

**FINAL PROOF SURVEY**

UNDER

Application No. G-9103 R-50231, 50240 Permit No. G-8792 R-8098, 44724  
IN NAME OF

TERRACE LAKE

Surveyed AUGUST 17, 1992, by R.W. Klassen

*K Klassen*  
*12-7-06*