

T. 8 S., R. 3 W., W.M.

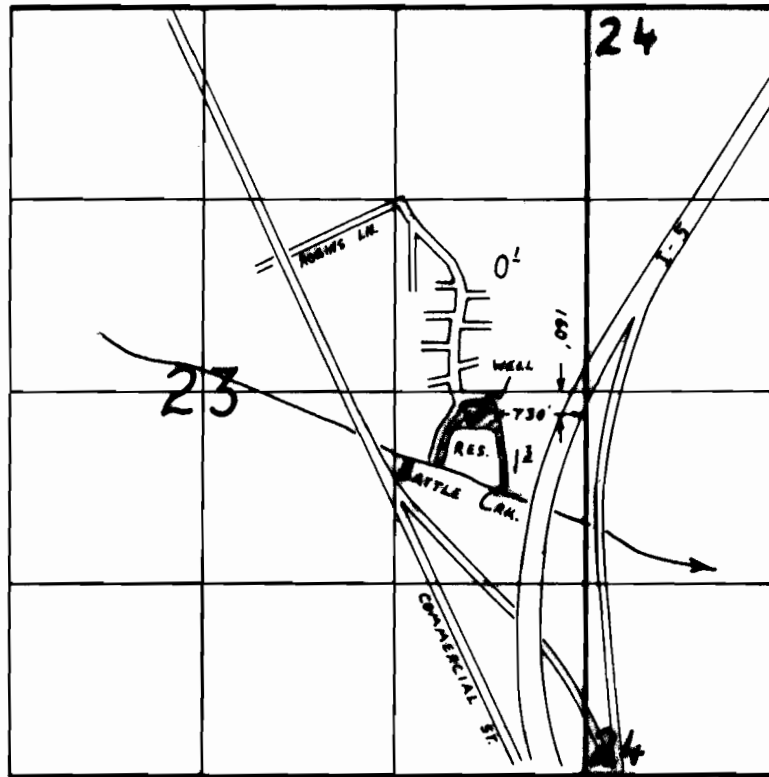

FINAL PROOF SURVEY

UNDER

Application No. G-9103 R-50231, 50240 Permit No. G-8792 R-6090, 44724
IN NAME OF

TERRACE LAKE

Surveyed AUGUST 17, 1992, by R.W. Klassen

WORK COPY

T. 8 S., R. 3 W., W.M.

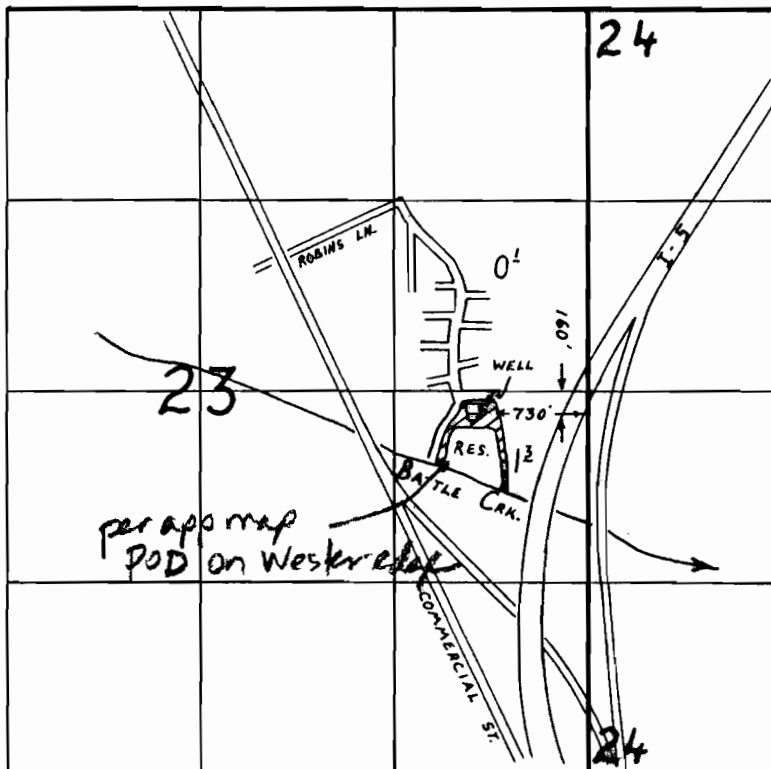

Reservoir POD = 500 feet South and 1000 feet West
from NE CORNER, NESE, SEC 23
(E¹/₄ CORNER)

FINAL PROOF SURVEY

UNDER

Application No. G-9103
A-58231, 58240 Permit No. G-8792
A-8098, 44724
IN NAME OF

TERRACE LAKE

Surveyed AUGUST 17, 1992, by R.W. Klassen

K Kavanagh
12-7-06