

Original map in 63772

T. 8 S., R. 25 E., W.M.

RECEIVED

MAR 31 1997
WATER RESOURCES DEPT.
SALEM, OREGON

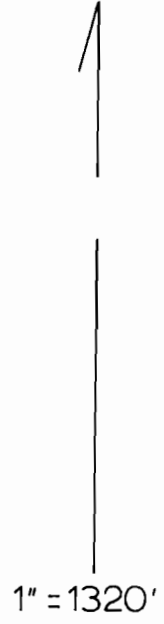
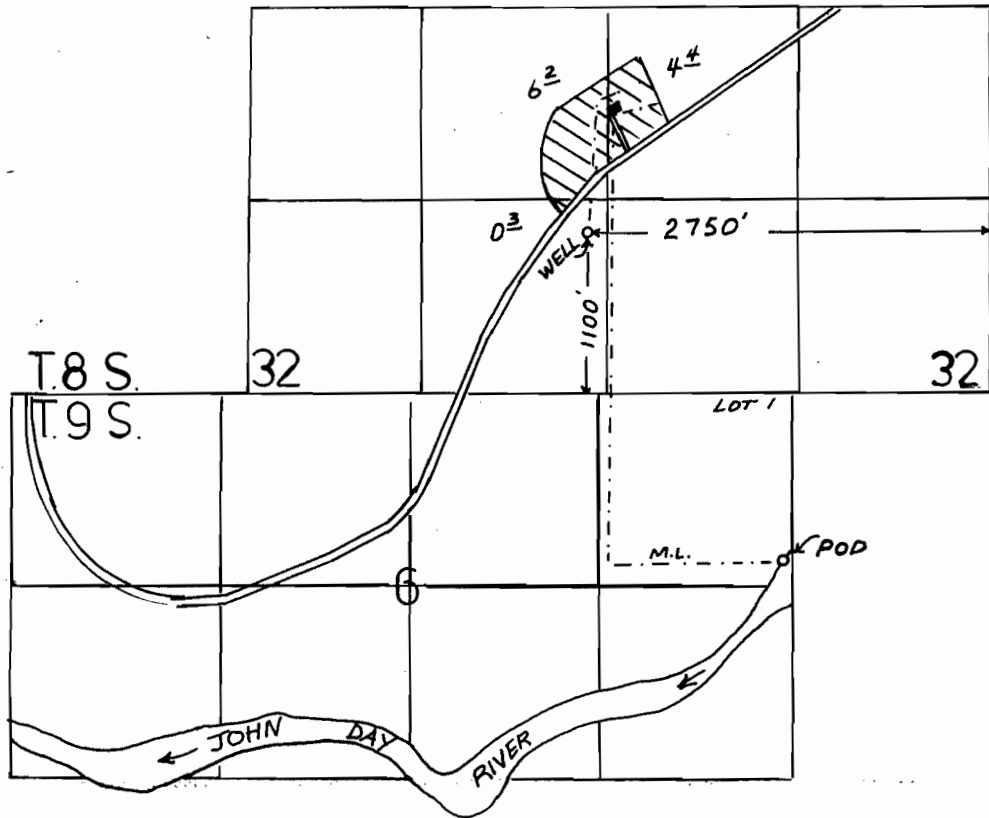

POD River 1130' S. & 50' W. of the NE Cor., Sec. 6.

FINAL PROOF SURVEY UNDER

Application No. 63772 G-10778 Permit No. 46998 G-9871
IN NAME OF

..... DON J. AND JOANN GRIFFITH

Surveyed MAY. 18... 1995... by J. Miller.....