

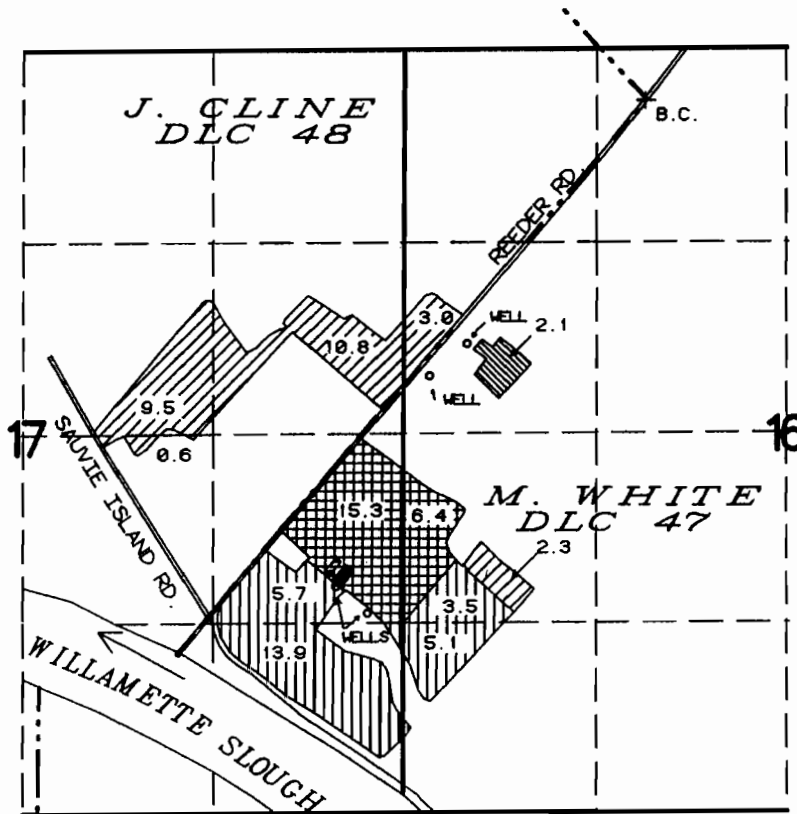





# T. 2 N., R. 1 W., WM



1" = 1320 FT

-  GREENHOUSE
-  G-9539 PRIMARY IRR.
-  G-9541 SUPPLEMENTAL IRR.  
G-9539 SUPPLEMENTAL IRR.
-  G-9539 SUPPLEMENTAL IRR.
-  G-9540 PRIMARY IRR.  
G-9753 SUPPLEMENTAL IRR.
-  CONTAINERIZED STOCK  
(0.1 ACRE)

WELL LOCATION FOR PERMIT  
 9753 - 2020 FT S AND 440 FT E FROM THE NW CORNER SECTION 16  
 9540 - 2240 FT S AND 180 FT E FROM THE NW CORNER SECTION 16  
 9541 - 1560 FT N AND 460 FT W FROM THE SE CORNER SECTION 17  
 9539 - 1380 FT N AND 250 FT W FROM THE SE CORNER SECTION 17

## FINAL PROOF SURVEY

UNDER

G-9743  
 G-9744  
 G-9745

G-9539  
 G-9540  
 G-9541

Application No.: G-10632      Permit No.: G-9753

IN THE NAME OF  
 PACIFIC COAST NURSERY

Surveyed: MAY 13, 1987

By: T. M. WARREN