

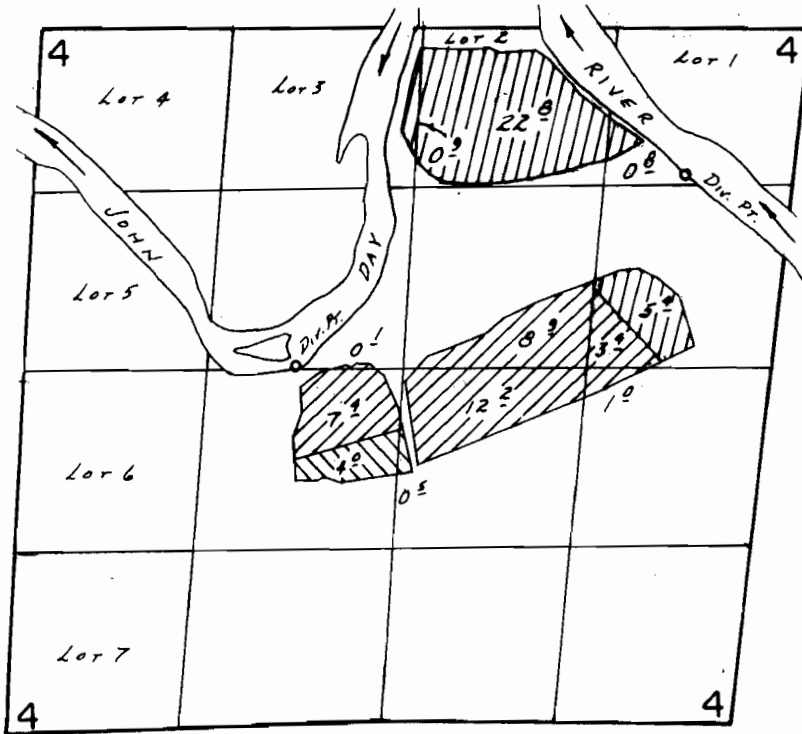

T. 8S., R. 19E., W.M.

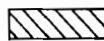

Div. Pts. Loc.: 2430' N. & 3000' W.; 3780' N. & 350' W., BOTH FROM SE COR. SEC. 4.

-  T-3689 1907 Priority
-  T-3689 6/18/27 Priority
-  Permit 42532

SCALE: 1" = 1320'

## FINAL PROOF SURVEY UNDER

Transfer Nos. 3689 & 5970  
Application No. 55996... Permit No. 42532.....  
IN NAME OF

.....H. KELLY MCGREER.....

Surveyed ..Aug. 12.. 19.88., by B.W. BISHOP.....

11/4/89

PTS W-1988

BWB