

# FINAL PROOF MAP

8476 FOR  
~~T-8376~~ PERMIT G-4050  
WILLOW FARMS, LLC  
T2N, R23E. WM

RECEIVED

MAR 15 2007

WATER RESOURCES DEPT  
SALEM, OREGON

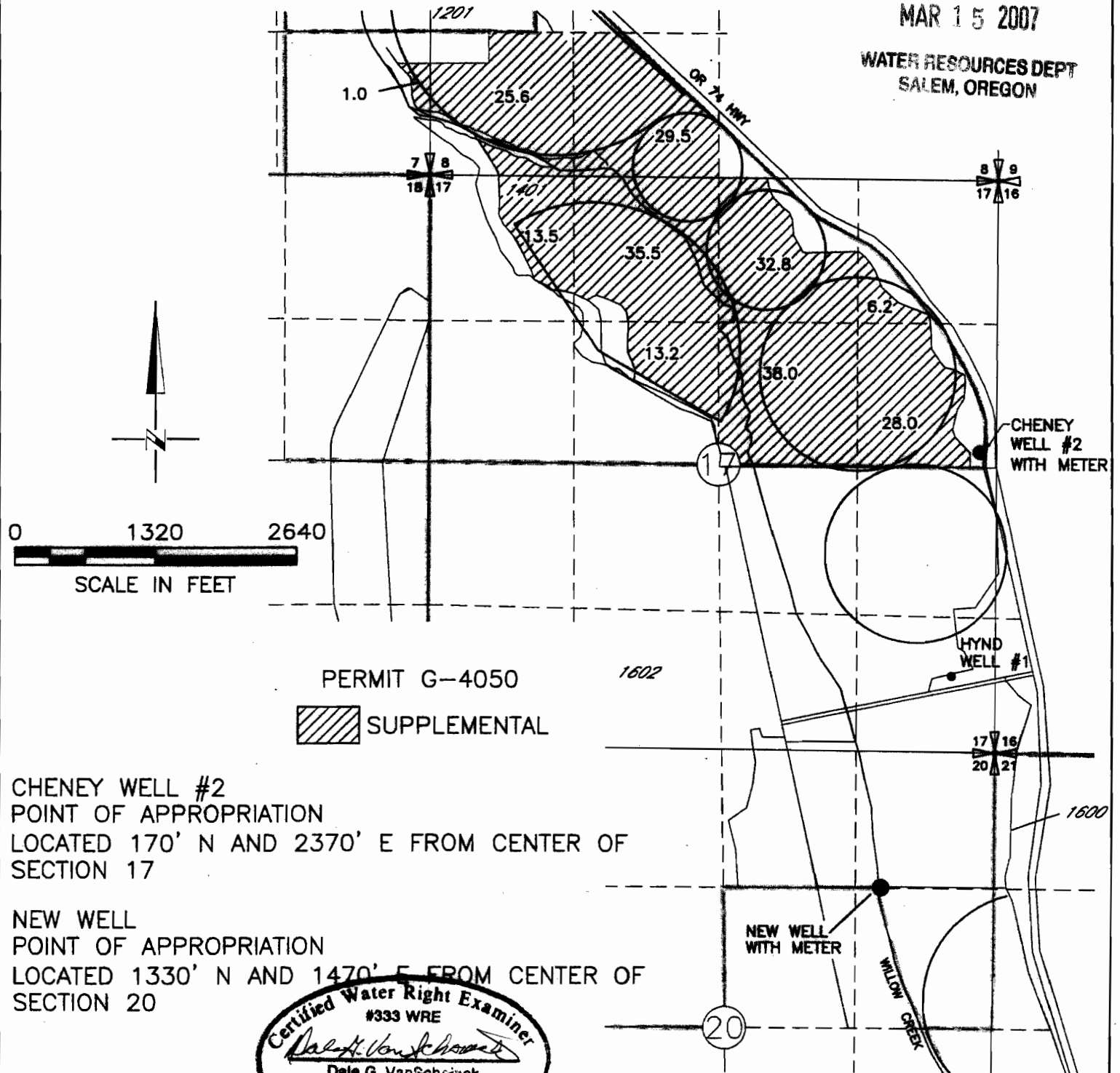

PERMIT G-4050  
[Hatched Box] SUPPLEMENTAL

CHENEY WELL #2  
POINT OF APPROPRIATION  
LOCATED 170' N AND 2370' E FROM CENTER OF  
SECTION 17

NEW WELL  
POINT OF APPROPRIATION  
LOCATED 1330' N AND 1470' E FROM CENTER OF  
SECTION 20

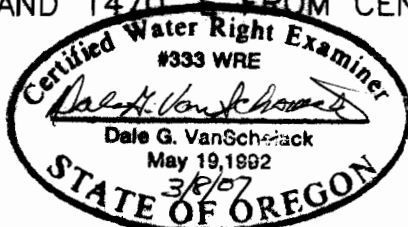

DRAWING: H:\CAD\AG\3522\304\35222-4FP.dwg  
PRINTED BY: Roger Willard on 03/08/07 10:59 AM

NOTE: THE PURPOSE OF THIS MAP IS TO IDENTIFY THE APPROXIMATE LOCATION OF THE WATER RIGHT. IT IS NOT INTENDED TO PROVIDE INFORMATION RELATIVE TO THE LOCATION OF PROPERTY OWNERSHIP BOUNDARY LINES.

