

T. 9 S. R. 1 W. W.M.

RECEIVED

SEP 16 1999

RESOURCES DEPT
SALEM, OREGON

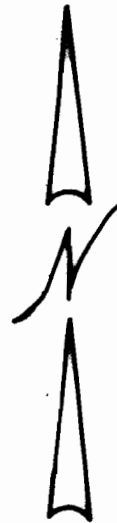
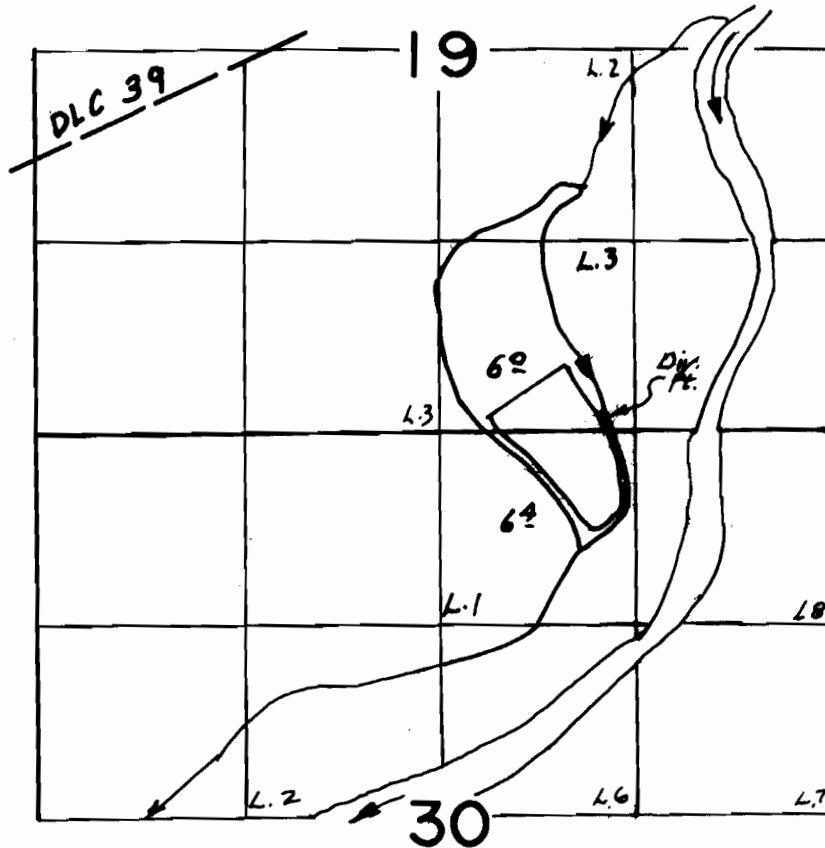

Scale
4" = 1 Mi.

DIV. PT. 10c. 80' N & 3880' E FROM SW COR SEC. 19

**FINAL PROOF SURVEY
UNDER**

Transfer No. T-7337
Application No. Permit No.
IN NAME OF

MILLER FORESTS, INC.

Surveyed July 6, 1999, by

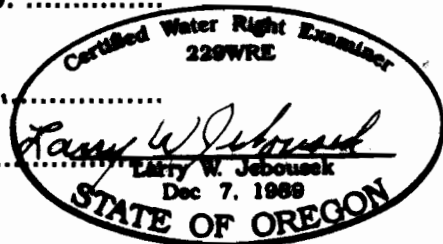

THIS MAP WAS PREPARED FOR THE PURPOSE OF IDENTIFYING THE LOCATION OF A WATER RIGHT ONLY AND IS NOT INTENDED TO PROVIDE LEGAL DIMENSIONS OR LOCATION OF PROPERTY OWNERSHIP LINES.

WAC-ODFW-93 5-133