

T. 7 & 8 S. R. 3 W. W. M.

STATE OF OREGON
S. DEPT.
S. 1500.00

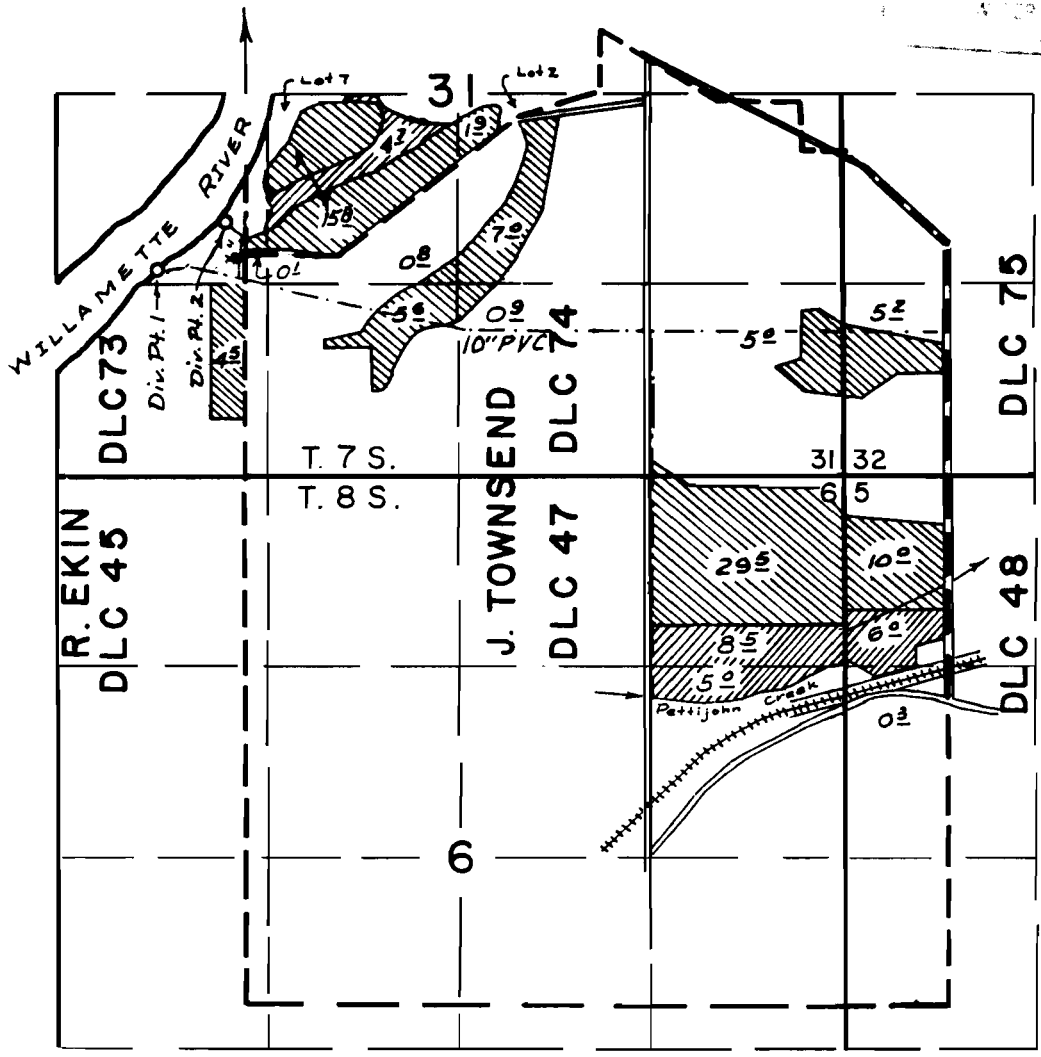

Scale 1" = 1320'

 1 1/2 A.F. Suppl.
  2 A.F. stored water only

Div. Pt. 1 located 1440' N & 660' E from SW Cor. Sec. 31
 Div. Pt. 2 located 200' N. & 150' W. from NW Cor. Townsend DLC 74

FINAL PROOF SURVEY

UNDER

Application No. 72634 Permit No. 52039
 IN NAME OF

MILLER FORESTS, INC.

Surveyed June 26, 2000, by

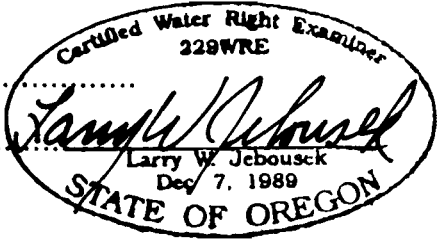

THIS MAP WAS PREPARED FOR THE PURPOSE OF IDENTIFYING THE LOCATION OF A WATER RIGHT ONLY AND IS NOT INTENDED TO PROVIDE LEGAL DIMENSIONS OR LOCATION OF PROPERTY OWNERSHIP LINES.