

# T.3S., R.1W., W.M.

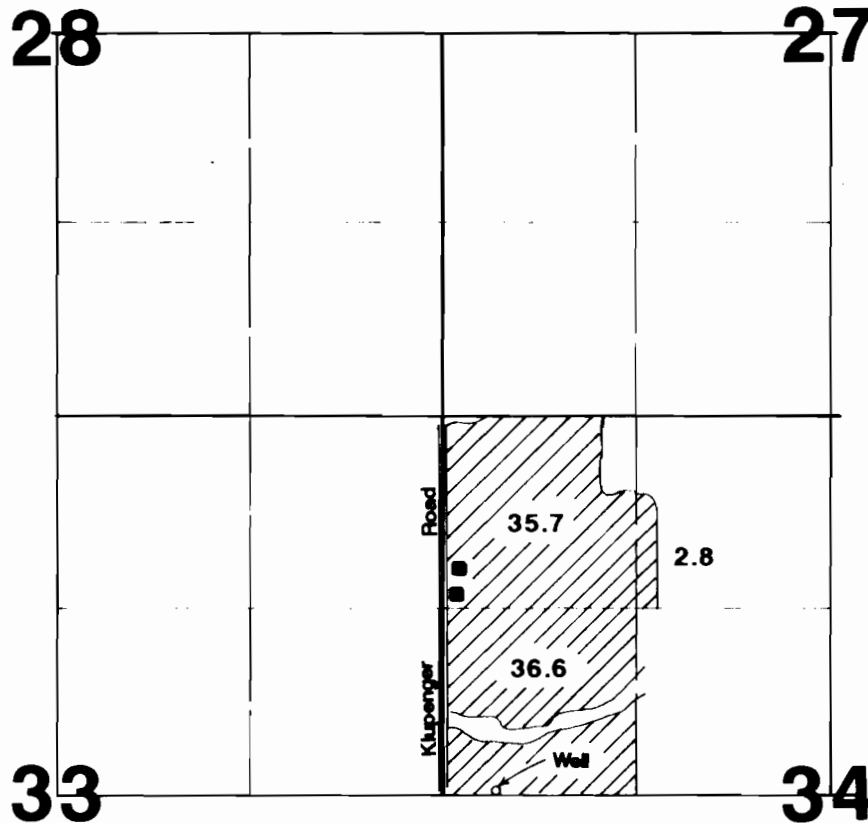

1" = 1320'



Well located 10'N & 352'E from W¼ corner Section 34.

## Final Proof Survey



Application #: G-11750

Permit #: G-10853

In Name Of

## Klupengers Nursery & GHSE, Inc.

Surveyed on March 26, 1994 by JM Schuette

THIS MAP WAS PREPARED FOR THE PURPOSE OF IDENTIFYING THE LOCATION OF A WATER RIGHT ONLY AND IS NOT INTENDED TO PROVIDE LEGAL DIMENSIONS OR LOCATION OF PROPERTY OWNERSHIP LINES.